

**ROYAL**   
**BOTANIA**



Until not so long ago, luxury and elegant design were mostly confined to indoor spaces, rarely extending outdoors.

Our ambition was to change that. Thus, we established the Royal Botania brand in April 1992, marking the beginning of our pursuit of perfection and our mission to make a lasting difference.

What defines us today and shapes our identity? It's not only the aesthetic beauty or ergonomic refinement of our designs. Nor is it the clever technical aspects, the subtle details, or the premium materials crafted by skilled artisans. Above all, it's our passion, a passion that drives us to go further, to create with purpose, and to bring excellence to every piece we make.

It is this passion that fills us with pride every time the Royal Botania logo is placed on a piece as it departs our factory, destined for a stunning terrace somewhere in the world.

As the years pass, it brings me great joy to see this same passion embraced by a new generation, one that shares the same devotion to design, craftsmanship, and innovation.

We invite you to indulge in finesse, and to partake in our happiness and celebration of all that is exquisite.

Kris Van Puyvelde  
FOUNDER



# Table of Contents

## LOUNGE SETS

22	Alura Lounge
28	Archy Lounge
40	Calypso lounge
48	Mambo Lounge
56	Mozaix Lounge
64	Ninix Lounge
68	Organix Lounge
78	Styletto Lounge
88	Zenhit Lounge

## CHAIRS

98	Alura
102	Archy
110	Calypso
114	Carés
120	Cordiz
124	Exes
128	Folia
136	Jive
142	Mambo
146	Ninix
148	Ostrea
152	O-zon
154	Strappy
162	Styletto
166	Zenhit

## TABLES

174	Butler
178	Conix
182	Exes
186	Furniz
194	Ninix
196	Styletto
202	Regaliz
216	U-nite
222	Traverse
224	Zidiz

## **SUN LOUNGERS**

232 Alura  
236 Ninix  
240 O-zon  
244 QT  
246 Strappy  
248 Styletto  
254 Tuskany  
258 Zenhit

## **PARASOLS**

264 Bloom  
266 Oazz  
268 Palma  
272 Shady  
274 Shady Slim  
272 Solaz

## **LIGHTING & ACCESSORIES**

282 Club lounge Light  
284 Dome Light  
286 Meduz Light  
288 Luniz Light  
290 Ropy Light  
292 Tristar Light

296 Bariq Planter  
298 Botaniq Planter  
300 Cuprum Planter

304 Tono pouf

306 Rugs

**MAINTENANCE - 308**

**COVERS - 310**

**THE GLASSHOUSE - 312**

**PROJECTS - 318**





# Our Teak Plantation

## EN

Attributable to its enormous stability, its renowned resistance to the elements, and its attractive hue and structure, teakwood is widely considered the noblest of all wood species. We only select the very best mature teakwood for our products. Our dedicated team constantly monitors the legality and the full traceability back to the origin of every single piece of wood used in our production. As we consider it our obligation to give more to the planet than we consume, Royal Botania has set up Green Forest Plantation Co. in 2010, and created a plantation with a surface area of about 200 hectares (i.e. 500 acres). Between 2011 and 2014, over 250.000 teak trees were planted there. They are doing great, and are growing well. Thus, our future generations will also be able to harvest and appreciate this natural treasure called *Tectona Grandis*.

## NL

Door de enorme stabiliteit, de bekende weerstand tegen de elementen, de aantrekkelijke kleur en structuur, wordt teakhout algemeen beschouwd als de nobelste van alle houtsoorten. Natuurlijk selecteren wij alleen het allerbeste rijpe teakhout voor onze producten. Ons toegewijde team waakt voortdurend over de volledige traceerbaarheid tot aan de oorsprong van elk stukje hout dat bij onze productie wordt gebruikt. Omdat wij vinden dat er meer aan de planeet moet gegeven worden dan dat wij consumeren, heeft Royal Botania de Green Forest Plantation Co opgezet in 2011, een plantage met een oppervlakte van ongeveer 200 hectare. Tussen 2011 en 2014 werden er meer dan 250.000 teakbomen geplant. Ze doen het goed en groeien sterk. Zo zullen onze toekomstige generaties ook deze natuurlijke schat, *Tectona Grandis*, kunnen oogsten en waarderen.

## FR

Particulièrement stable et résistant, le bois de teck qui est également considéré comme l'une des essences les plus nobles, attire aussi bien par sa couleur que par sa texture. Nous sélectionnons uniquement les arbres les plus matures. Notre équipe passionnée assure la tracabilité de chaque pièce de bois utilisée pour la fabrication de nos produits, jusqu'à l'origine. Nous assumons nos responsabilités et nous souhaitons rendre à la planète ce que nous consommons, c'est pourquoi Royal Botania a créé la Green Forest Plantation Co. en 2011 par la mise en place d'une plantation d'environ 200 hectares. Entre 2011 et 2014, plus de 250 000 tecks ont été plantés. Ils poussent très bien. Les générations futures auront donc la chance de récolter et de travailler ce trésor naturel également connu sous le nom de *Tectona Grandis*.

## *Over 250.000 teak trees were planted*

### ES

Dada su gran estabilidad, su afamada resistencia a las inclemencias del tiempo y su atractiva tonalidad y estructura, muchos consideran que la madera de teca es de las más nobles del mundo. Sobra decir que solo seleccionamos los mejores árboles y los más maduros para fabricar nuestros productos. Nuestro equipo controla de manera constante la trazabilidad de todos y cada uno de nuestros productos. Así podemos saber de dónde proviene la madera que empleamos. Además, como creemos que es nuestra obligación devolverle al planeta más de lo que él nos da, Royal Botania fundó Green Forest Plantation Co. en 2011 y puso en marcha una plantación cuya superficie ronda las 200 hectáreas. Entre 2011 y 2014, allí se plantaron más de 250 000 *Tectona grandis* (o tecas). Y están creciendo fuertes y robustas. De esta forma, las generaciones futuras también podrán cuidar y apreciar este tesoro nacional.

### DE

Aufgrund seiner enormen Stabilität, seiner besonderen Widerstandsfähigkeit, seiner ansprechenden Färbung und Struktur gilt Teakholz allgemein als das Edelste aller Hölzer. Natürlich verwenden wir für unsere Produkte nur Teakholz, das unseren Ansprüche an höchste Qualität genügt. Unser engagiertes Team überwacht konsequent die lückenlose Rückverfolgbarkeit jedes einzelnen Holzstücks, das in unserer Produktion verwendet wird. Ebenso ist Nachhaltigkeit eines unserer Handlungsprinzipien bezüglich der Ressourcen-Nutzung. Um die Regenerationsfähigkeit von Teakholz zu gewährleisten haben wir Royal Botania —die Green Forest Plantation Co. ins Leben gerufen. Diese Organisation hat im Jahr 2011 eine Teakholz-Plantage mit einer Fläche von etwa 200 Hektar aufgeforstet. Zwischen 2011 und 2014 sind dort über 250.000 Teakbäume gepflanzt worden, die kontinuierlich wachsen. So stellen wir sicher, dass auch die Bedürfnisse künftiger Generationen berücksichtigt werden.

### IT

Data la sua enorme stabilità, la sua nota resistenza alle intemperie e la sua affascinante tonalità e struttura, il tek è ampiamente considerato come il più nobile di tutti i tipi di legno. Ovviamente, per i nostri prodotti, selezioniamo solo il miglior tek maturo. Il nostro team dedicato controlla costantemente la completa tracciabilità di ogni singolo pezzo di legno utilizzato nei nostri reparti di produzione partendo dalle origini. Poiché riteniamo un nostro dovere dare al pianeta più di quanto consumiamo, Royal Botania ha istituito la Green Forest Plantation Co. nel 2011 e ha creato una piantagione con una superficie di circa 200 ettari (500 acri). Tra il 2011 e il 2014, vi sono stati piantati oltre 250.000 alberi di tek. Stanno benissimo e crescono bene. Così, le nostre future generazioni saranno in grado di raccogliere e apprezzare questo tesoro naturale chiamato *Tectona Grandis*.





# Our Designs

## EN

Each Royal Botania design focusses on 3 key elements: aesthetics, ergonomics and engineering. These ingredients determine the DNA of every single concept. Blending them together while fine-tuning the balance is our basic recipe. The eye for detail and the exquisite finish come as complementary toppings. With this formula, our in-house design team, led by our founder Kris Van Puyvelde, has earned international appreciation, and won multiple design awards on both sides of the Atlantic. Additionally, we engage the talents of carefully selected freelance designers, to broaden our horizon. All of this creativity has resulted in a wide range of charismatic products, rich in variety, known as the Royal Botania collection.

## NL

Elk ontwerp van Royal Botania is gebaseerd op 3 belangrijke elementen; esthetiek, ergonomie en engineering. Zij bepalen het DNA van elk concept. Het mengen van deze ingrediënten en het fine-tunen van hun evenwicht is ons basisrecept. Het oog voor details en de verfijnde afwerking zijn de saus. Met deze formule heeft ons in-house designteam, onder leiding van oprichter Kris Van Puyvelde, internationale waardering geoost en meerdere designprijzen gewonnen aan beide kanten van de Atlantische Oceaan. Daarnaast doen wij beroep op het talent van door ons zorgvuldig geselecteerde externe ontwerpers om onze horizon te verbreden. Al deze creativiteit heeft geleid tot een breed gamma charismatische producten, bekend als de Royal Botania-collectie.

## FR

Tous les modèles Royal Botania sont développés selon trois principes clés : l'esthétisme, l'ergonomie et la technicité. Ces valeurs sont au coeur de nos créations originales. En combinant ces trois facteurs, nous obtenons des modèles raffinés et équilibrés. Notre sens du détail et les finitions exceptionnelles donnent vie à de véritables oeuvres d'art. Grâce à cette formule magique, notre équipe de créateurs menée par Kris Van Puyvelde est aujourd'hui reconnue sur la scène internationale et a été primée à plusieurs reprises des deux côtés de l'Atlantique. Nous faisons également appel au talent de créateurs extérieurs afin d'élargir nos horizons. Toute cette énergie alliée à une créativité débordante nous permet de vous proposer des produits de charme dans cette collection Royal Botania.

*“ To those who have experienced passion for  
finesse, the ordinary will no longer appeal. ”  
- Willem Elschot*

## ES

Todos los diseños de Royal Botania comparten tres elementos clave: estética, ergonomía e ingeniería. Esos tres aspectos forjan el ADN de todos nuestros diseños. Nuestra receta consiste en mezclar esos ingredientes y lograr el equilibrio perfecto entre ellos. La pasión por los detalles y el acabado exquisito son la guinda del pastel. Con esa forma de trabajar, el equipo de diseño, encabezado por nuestro fundador Kris Van Puyvelde, se ha hecho con el reconocimiento de la comunidad internacional y ha ganado múltiples premios de diseño a ambos lados del Atlántico. Asimismo, contratamos de forma muy minuciosa a diseñadores externos para ampliar nuestros horizontes. Toda esa creatividad nos permite crear una amplia gama de productos con personalidad propia: la colección Royal Botania.

## DE

Jedes Konstruktion und Gestaltung von Royal Botania Produkten basiert auf drei Schlüsselementen: der Ästhetik, der Ergonomie und der Bautechnik. Diese Bausteine bestimmen die DNA jedes einzelnen Entwurfs. Die Kombination dieser grundlegenden Elemente mit gleichzeitiger Feinabstimmung ist unser Erfolgsrezept. Ein gutes Auge fürs Detail, solide Verarbeitung und ein perfektes Finish liefern ein optimales Ergebnis. Mit dieser Formel hat unser internes Designteam unter der Leitung von Kris Van Puyvelde international Anerkennung und Design-Preise erlangt. Ferner binden wir Talente sorgfältig ausgewählter externer Designer ein, um unseren Erfahrungshorizont zu erweitern. All dies hat zu einer breiten Palette inspirierend-kreativer, hochwertiger Produkte geführt, die als Royal Botania-Kollektion bekannt ist.

## IT

Ciascuno dei design di Royal Botania si basa su 3 elementi chiave; estetica, ergonomia e ingegneria. Questi determinano il DNA di ogni singola concezione. Unire insieme questi ingredienti, perfezionandone al tempo stesso l'equilibrio, è la nostra ricetta base. La cura nei dettagli e le pregevoli finiture rappresentano decorazioni complementari. Grazie a questa formula, il nostro team interno di design, guidato dal nostro fondatore Kris Van Puyvelde, ha guadagnato l'apprezzamento internazionale e vinto diversi premi di design su entrambe le sponde dell'Atlantico. Inoltre, ci avvaliamo del talento di designer esterni accuratamente selezionati, per ampliare i nostri orizzonti. Tutta questa creatività ha dato vita a un'ampia gamma di prodotti carismatici, conosciuti come la collezione Royal Botania.





# Our Production

## EN

To guarantee flawless products, we control every step of the production process. In 2002, we set up our own production plant, just outside Bangkok in Thailand. There we employ some 400 people, dedicated to making every produced piece worthy of the brand name Royal Botania. Under one 13.000m<sup>2</sup> roof, we have concentrated the skills, and state of the art machinery, to make that happen. Still, most of all, we care for our people. That is why we provide much more than just a safe and healthy working environment. We offer free on-site housing for our workers and their families, medical care, free English lessons, sport activities, and even a kindergarten for the little ones. The Royal Botania plant, is much more than just a high end furniture factory, it is a big, happy community!

## NL

Om vlekkeloze producten te garanderen, controleren we elke stap van het productieproces. In 2002 hebben we onze eigen productiefabriek opgezet, net buiten Bangkok in Thailand. Daar hebben we zo'n 400 mensen in dienst, toegewijd aan het maken van elk geproduceerd stuk dat de faciliteit verlaat, waardig aan de merknaam Royal Botania. Onder één dak van 13.000 m<sup>2</sup> hebben we de vaardigheden en de modernste machines geconcentreerd om dat te realiseren. Toch geven we vooral om onze mensen. Daarom bieden we veel meer dan alleen een veilige en gezonde werkomgeving. We bieden gratis huisvesting ter plaatse voor onze werknemers en hun families, medische zorg, gratis Engelse lessen, sportactiviteiten en zelfs een kleuterschool voor de kleintjes. De Royal Botania-fabriek is veel meer dan alleen een luxe meubelfabriek, het is een grote, gelukkige gemeenschap!

## FR

Pour garantir des produits impeccables, nous contrôlons chaque étape du processus de production. En 2002, nous avons créé notre propre usine de production, juste à l'extérieur de Bangkok en Thaïlande. Là, nous employons environ 400 personnes, dédiées à fabriquer chaque pièce quittant l'établissement, digne du nom de marque Royal Botania. Sous un toit de 13 000 m<sup>2</sup>, nous avons concentré les compétences et des machines à la pointe de la technologie pour y parvenir. Cependant, ce qui importe le plus pour nous, ce sont nos employés. C'est pourquoi nous offrons bien plus qu'un environnement de travail sûr et sain. Nous proposons un logement gratuit sur place pour nos employés et leurs familles, des soins médicaux, des cours d'anglais gratuits, des activités sportives et même une garderie pour les petits. L'usine Royal Botania, c'est bien plus qu'une simple usine de meubles haut de gamme, c'est une grande communauté heureuse!

## *The Royal Botania plant, is much more than just a high end furniture factory, it is a big, happy community!*

### ES

Para garantizar productos impecables, controlamos cada paso del proceso de producción. En 2002, establecimos nuestra propia planta de producción, justo afuera de Bangkok en Tailandia. Allí empleamos a unas 400 personas, dedicadas a hacer cada pieza producida digna del nombre de la marca Royal Botania. Bajo un techo de 13.000 m<sup>2</sup>, hemos concentrado las habilidades y la maquinaria de última generación para lograrlo. Aún así, lo más importante para nosotros es cuidar a nuestra gente. Por eso ofrecemos mucho más que un entorno de trabajo seguro y saludable. Ofrecemos alojamiento gratuito en el lugar para nuestros trabajadores y sus familias, atención médica, clases gratuitas de inglés, actividades deportivas e incluso un jardín de infancia para los más pequeños. La planta de Royal Botania es mucho más que una fábrica de muebles de alta gama, ¡es una gran comunidad feliz!

### DE

Um makellose Produkte zu garantieren, kontrollieren wir jeden Schritt des Produktionsprozesses. Im Jahr 2002 haben wir unser eigenes Produktionswerk, direkt außerhalb von Bangkok in Thailand, aufgebaut. Dort beschäftigen wir rund 400 Menschen, die sich der Herstellung jedes produzierten Stücks widmen, das die Anlage verlässt und dem Markennamen Royal Botania gerecht wird. Unter einem Dach von 13.000 m<sup>2</sup> haben wir die Fähigkeiten und modernste Maschinen konzentriert, um dies zu ermöglichen. Dennoch kümmern wir uns vor allem um unsere Mitarbeiter. Deshalb bieten wir viel mehr als nur eine sichere und gesunde Arbeitsumgebung. Wir bieten kostenlose Unterkünfte vor Ort für unsere Mitarbeiter und deren Familien, medizinische Versorgung, kostenlose Englischkurse, sportliche Aktivitäten und sogar einen Kindergarten für die Kleinen. Das Werk von Royal Botania ist weit mehr als nur eine High-End-Möbelfabrik, es ist eine große, glückliche Gemeinschaft!

### IT

Per garantire prodotti impeccabili, controlliamo ogni fase del processo produttivo. Nel 2002 abbiamo istituito il nostro stabilimento produttivo, appena fuori Bangkok in Thailandia. Lì impieghiamo circa 400 persone, dedicate a realizzare ogni singolo pezzo prodotto, degno del nome del marchio Royal Botania. Sotto un tetto di 13.000 m<sup>2</sup>, abbiamo concentrato le competenze e i macchinari all'avanguardia per farlo accadere. Tuttavia, soprattutto, ci prendiamo cura delle nostre persone. Ecco perché offriamo molto di più di un ambiente di lavoro sicuro e salutare. Offriamo alloggi gratuiti sul posto per i nostri lavoratori e le loro famiglie, assistenza medica, lezioni gratuite di inglese, attività sportive e persino un asilo nido per i più piccoli. Lo stabilimento Royal Botania è molto più di una semplice fabbrica di mobili di fascia alta, è una grande comunità felice!





# Lounge Sets





# Alura Lounge

The Alura Lounge embodies versatile design, perfect for crafting personalized outdoor setups. With three robust aluminum base sizes, you can configure pieces into single, double, or triple seaters and create L or U-shaped arrangements. Each piece features a sleek, sturdy structure supporting modular back and armrests. Choose from over 80 fabric options for the cushions, ensuring each arrangement is both comfortable and stylish.

The lounge integrates seamlessly with the wider Alura Collection, which includes matching dining chairs, armchairs, low chairs, bar chairs and a sun lounger, offering a cohesive and inviting outdoor living experience.







*The Alura Lounge was conceived with a clear design intention: to express strength through simplicity. Its sleek lines and all-aluminium construction create a refined, architectural presence that feels at home in both urban terraces and coastal landscapes.*

*Every contour serves purpose and balance, resulting in a lounge that is both visually light and structurally enduring.*





# Archy Lounge

The Archy Lounge marks a new chapter in the Archy collection, introducing lounge pieces defined by rounded teak contours and tactile warmth. Crafted from solid teak, the frame reveals the natural beauty and resilience of the wood. The timber is shaped into smooth, continuous tubes, each element rounded and softened to highlight the material's gentle character while ensuring lasting strength and durability.

The signature Archy sleeves wrap gracefully around the tubular backrest and are available in six shades: Pebble, Bronze, Brick, Sage, Espresso, and Cappuccino. A matching daybed completes the lounge, designed in the same materials and signature curves for a cohesive aesthetic.

With its modular elements and complementary tables, the collection offers endless possibilities for composition. Combined with six sleeve colour options and a variety of tabletop materials, Archy adapts effortlessly to any outdoor setting, from secluded terraces to open architectural spaces. Its design speaks of balance between strength and softness, tradition and innovation, craftsmanship and comfort.







The defining detail of the Archy Lounge lies in its distinctive sleeves, braided covers that wrap around the arched aluminium backrest. Crafted from thin fibres with a resilient polyester core and a soft, weatherproof coating, they combine refined texture with exceptional durability.

The material resists UV and moisture, dries quickly, and maintains its gentle touch over time. Available in six hues: Pebble, Bronze, Brick, Sage, Espresso and Cappuccino, the sleeves bring subtle contrast and personality to each configuration.













*In our own woodworking atelier in Thailand, experienced craftsmen shape mature solid teak with precision and care. Each curve and junction is refined by hand, bringing out the soft lines that define the Archy Lounge and revealing the quiet strength within the wood. Chosen for its resilience and natural warmth, teak lends the collection its timeless character, a balance of durability and elegance that endures through every season.*

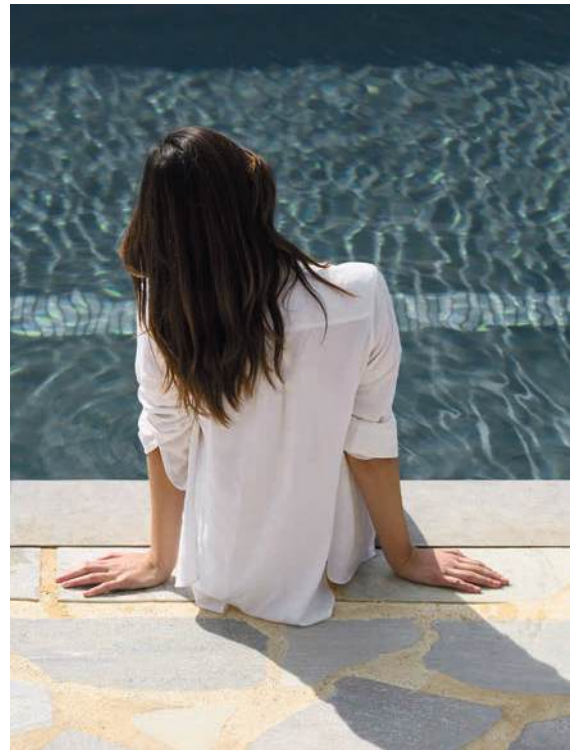





# Calypso Lounge



The Calypso Lounge collection brings a sense of relaxed sophistication to outdoor spaces. Its welcoming form and modular setup allow it to blend seamlessly into a variety of environments, from intimate terraces to expansive poolside arrangements.

Designed with adaptability in mind, Calypso offers endless ways to configure and personalize. Choose from different lengths, fabrics, and finishes to create a composition that feels tailored to your setting.



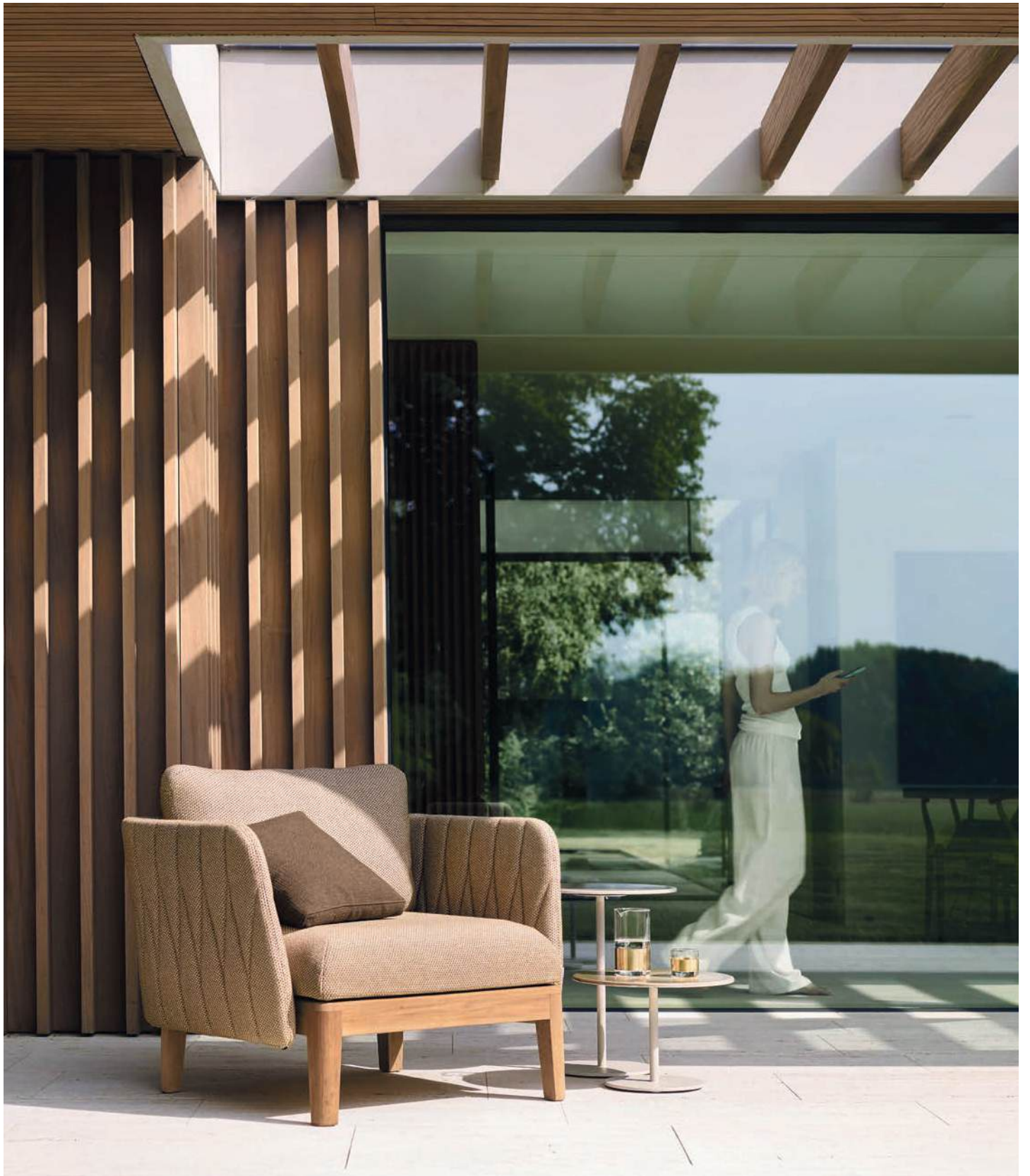











*The Calypso Lounge is available in two distinct expressions. The upholstered version embraces softness and comfort, offering a more cocooning experience.*

*The Kris Kross weave, on the other hand, reveals a crafted structure that feels light and open, defined by texture and rhythm.*

# Mambo Lounge

Designed by Kris Van Puyvelde, the Mambo Lounge Collection offers a perfect balance of comfort and style. The warm teak frame reveals the natural beauty of the wood, shaped with soft curves and refined proportions that express both strength and elegance.

Softly curved wooden profiles connect with generous cushions, creating a lounge that feels composed yet inviting. Whether you choose the compact two-seater or build a larger modular setup, Mambo adapts naturally to the rhythm of any outdoor space.

Matching Low Lounge tables complete the collection, uniting form and function in a coherent whole.







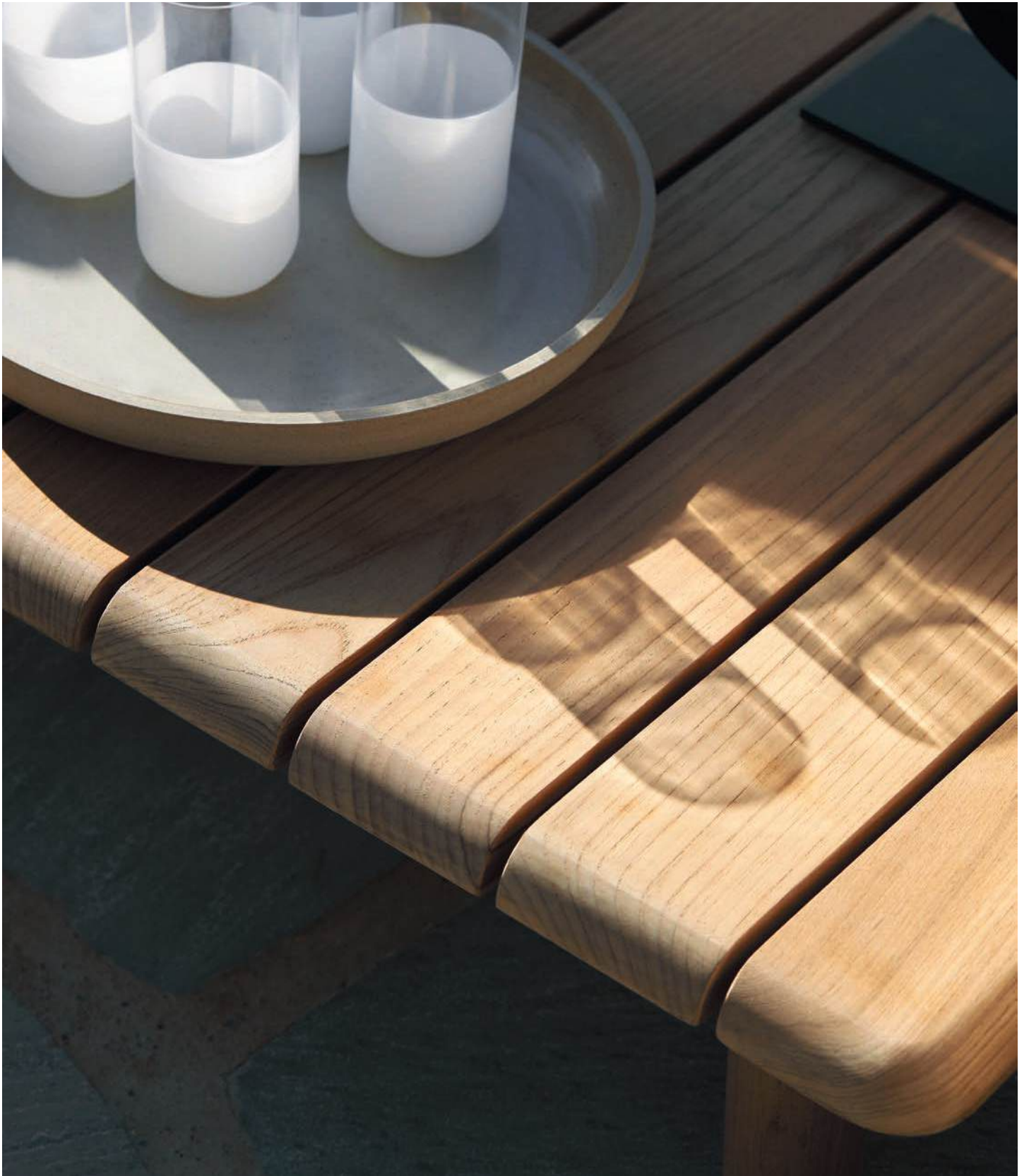

*What sets the Mambo Lounge apart is its concealed stainless steel framework, hidden within the teak structure. This inner skeleton provides remarkable strength and stability while allowing for the design's pure, effortless appearance. With the cushions in place, only the wrap-around armrests and four slender legs remain visible, giving the impression that the cushions are gracefully floating within the frame.*





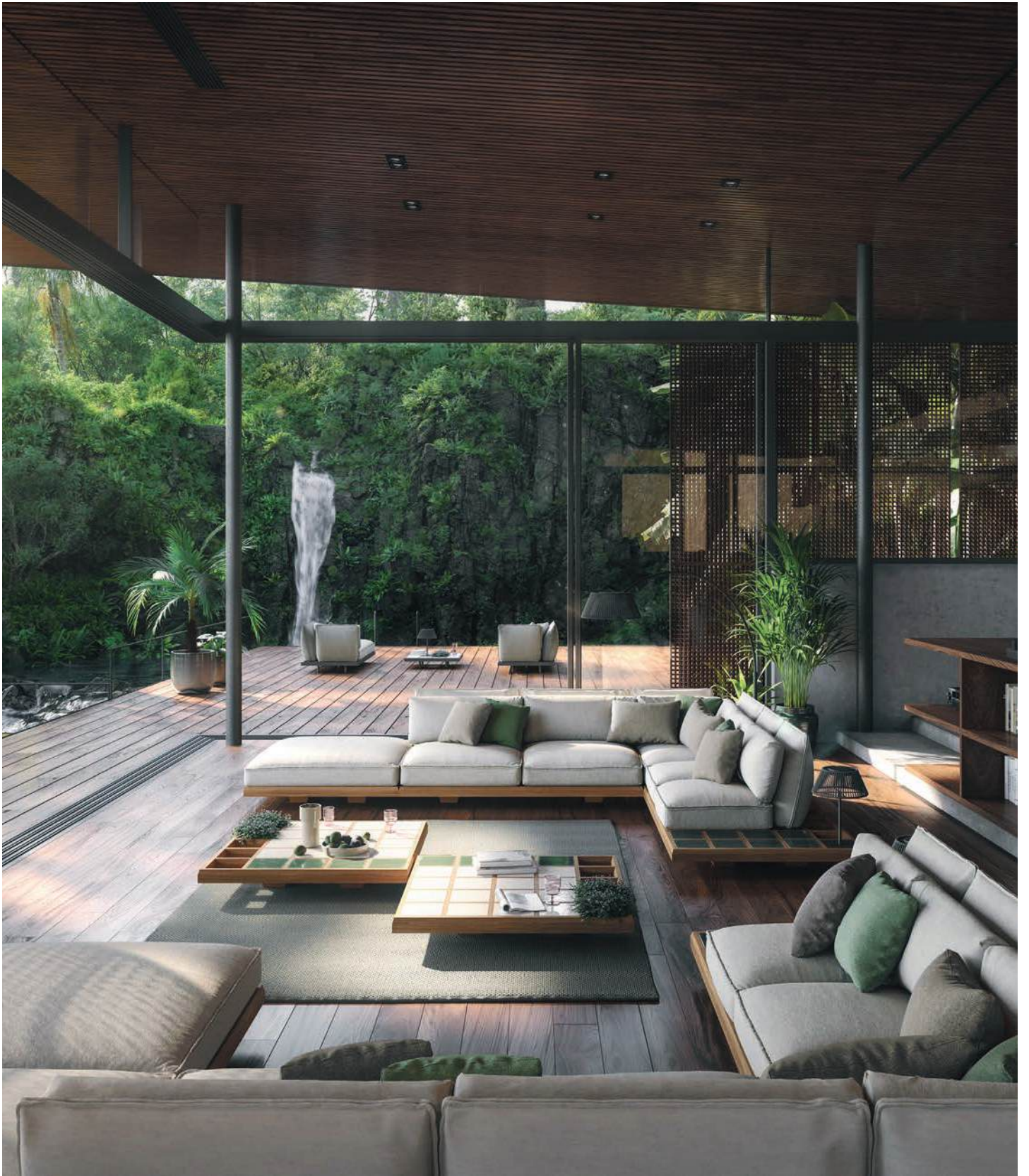

# Mozaix Lounge

Designed by Kris Van Puyvelde, the Mozaix lounge represents the pinnacle of luxury in outdoor furniture, combining refined aesthetics with exceptional comfort. Available in both premium teak and coated aluminum, this modular lounge system allows for endless customization, enabling you to create the perfect outdoor setting. The signature mosaic-like inlays, crafted from teak, lavastone, lights or even flower pots offer a stunning visual centerpiece that enhances its opulent feel.



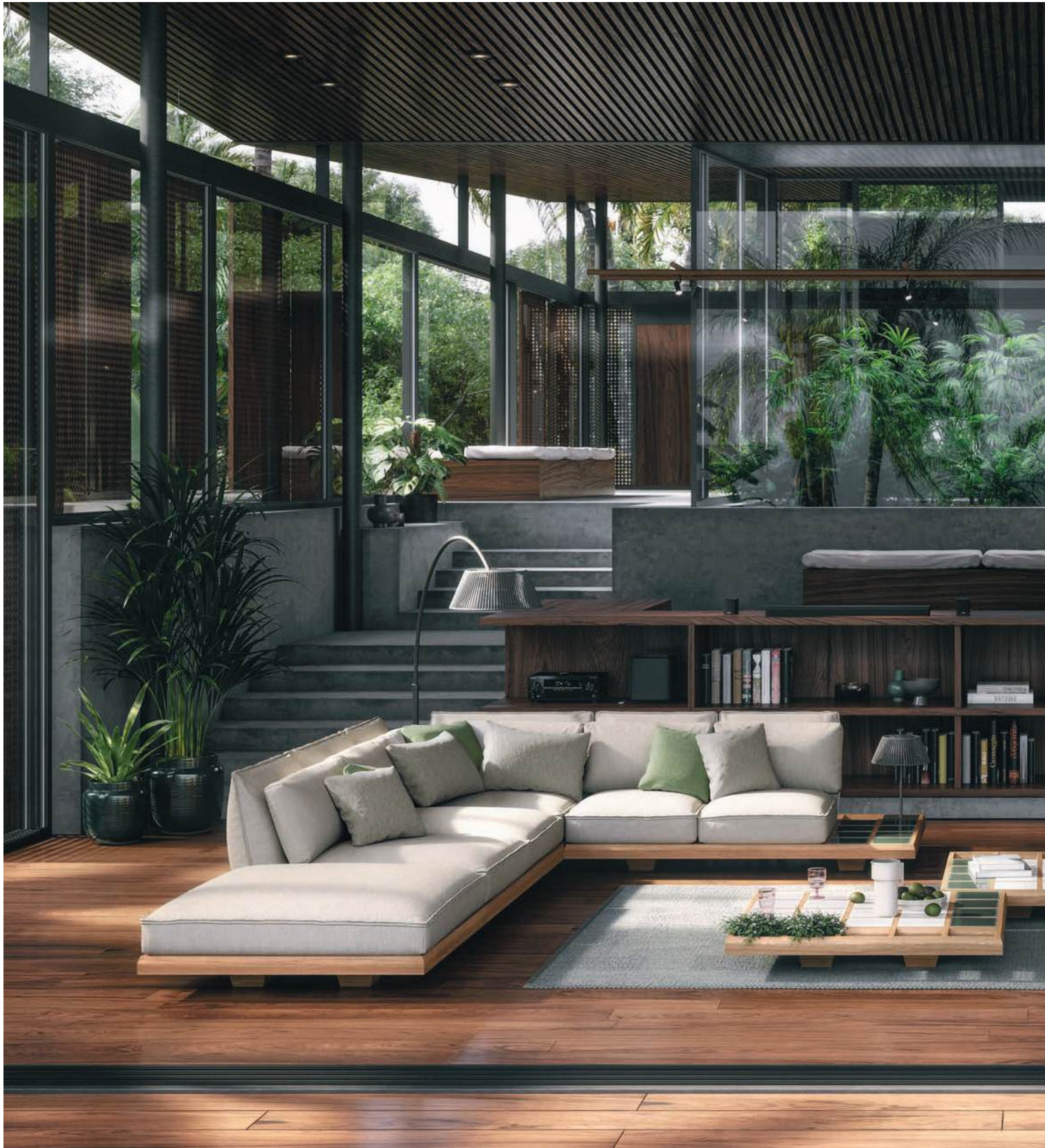











*Engineered for durability and outdoor resilience, the Mozaix lounge features weather-resistant cushions and materials designed to endure the elements while maintaining their elegance. Whether in teak or aluminum, this piece redefines outdoor sophistication, positioning itself as one of the most luxurious lounges ever created.*



The Ninix Lounge Collection embodies the essence of refined outdoor living through its minimalist design and enduring construction. The sleek stainless steel frames, paired with optional teak armrests, create a timeless balance of elegance and durability, designed to withstand the elements with ease.

Uphostered with Batyline slings, renowned for its resistance to UV rays, mildew, and stains, the Ninix ensures both lasting comfort and practicality. With customizable finishes, the collection offers the flexibility to tailor each piece to your personal style, making the Ninix Lounge a symbol of understated luxury in any outdoor setting.

# Ninix Lounge









When Kris Van Puyvelde first envisioned the Organix Lounge, outdoor furniture was still defined by geometry and structure. Curves belonged to nature, not to design. Yet he imagined something different: a lounge that would follow the organic flow of the landscape itself, where softness and form could coexist in perfect balance.

What emerged was a collection unlike anything seen before. With its gentle curves, fluid silhouettes and distinctive kidney-shaped forms, Organix marked a turning point in outdoor design as the first to introduce free-flowing, organic shapes to the world of refined outdoor living. Inspired by nature yet unmistakably contemporary, it remains an icon of sculptural elegance.

Whether arranged as an intimate setting or a generous landscape, Organix reflects the art of balance between softness and strength, design and ease. It remains a timeless expression of Royal Botania's pioneering spirit in outdoor living.



# Organix Lounge







Fixed back cushions form a continuous line that offers gentle structure, while the deep seat cushions invite a sense of ease and relaxation. Each module stands beautifully on its own yet connects effortlessly to form larger, flowing compositions.



Its soft, rounded lines rest lightly on slender legs, creating a harmonious contrast between volume and precision. Originally conceived with aluminium feet, the lounge is now also available with teak legs, adding a natural warmth that enhances its tactile appeal.



*Designed for moments that matter, with family,  
with friends, with time to simply be. The generous  
comfort of Organix invites you to unwind and  
enjoy the ease of being together.*







# Styletto Lounge

The Styletto Lounge draws its name and inspiration from the elegance of the stiletto heel. Just like its namesake, it stands out through its slender, tapered legs, a refined detail that gives the collection a sense of lightness and poise.

This modular collection offers a sophisticated blend of style and functionality. Its deeper seating invites relaxation, while teak or ceramic topped tables echo the same graceful geometry. Designed for adaptability, Styletto allows endless compositions to suit both intimate and generous outdoor settings. For larger arrangements, the impressive 220 or 300 cm low lounge tables create a seamless visual anchor.

The latest addition, the twin seat, completes the ensemble. It can be used as a lounge corner or as a spacious daybed, extending comfort and versatility even further.

With its sculptural legs and refined proportions, the Styletto Lounge embodies contemporary elegance: light, balanced, and timeless.





*The Styletto Lounge collection is crafted to deliver unparalleled comfort and timeless elegance, making it a versatile choice for luxury outdoor living.*









The wheel units are masterfully integrated into the tapered legs of the Styletto collection, keeping them visually discreet and perfectly aligned with the lounge's refined, minimalist aesthetic.



We designed a dedicated version of the Butler 40, proportioned to sit just above our lounge cushions, offering an effortlessly accessible surface while preserving the clean, understated elegance of the collection.





# Zenhit Lounge

The Zenhit Lounge embodies the essence of refined outdoor living. Crafted from solid teak, each piece is defined by its generous proportions and serene balance between structure and comfort.

Available as individual chairs, corner units, two- and three-seaters, and left- or right-handed daybeds, the collection brings a sense of unity to any outdoor space. Whether arranged as a lounge ensemble or combined with low dining tables, Zenhit creates a setting made for relaxation and long, effortless gatherings.

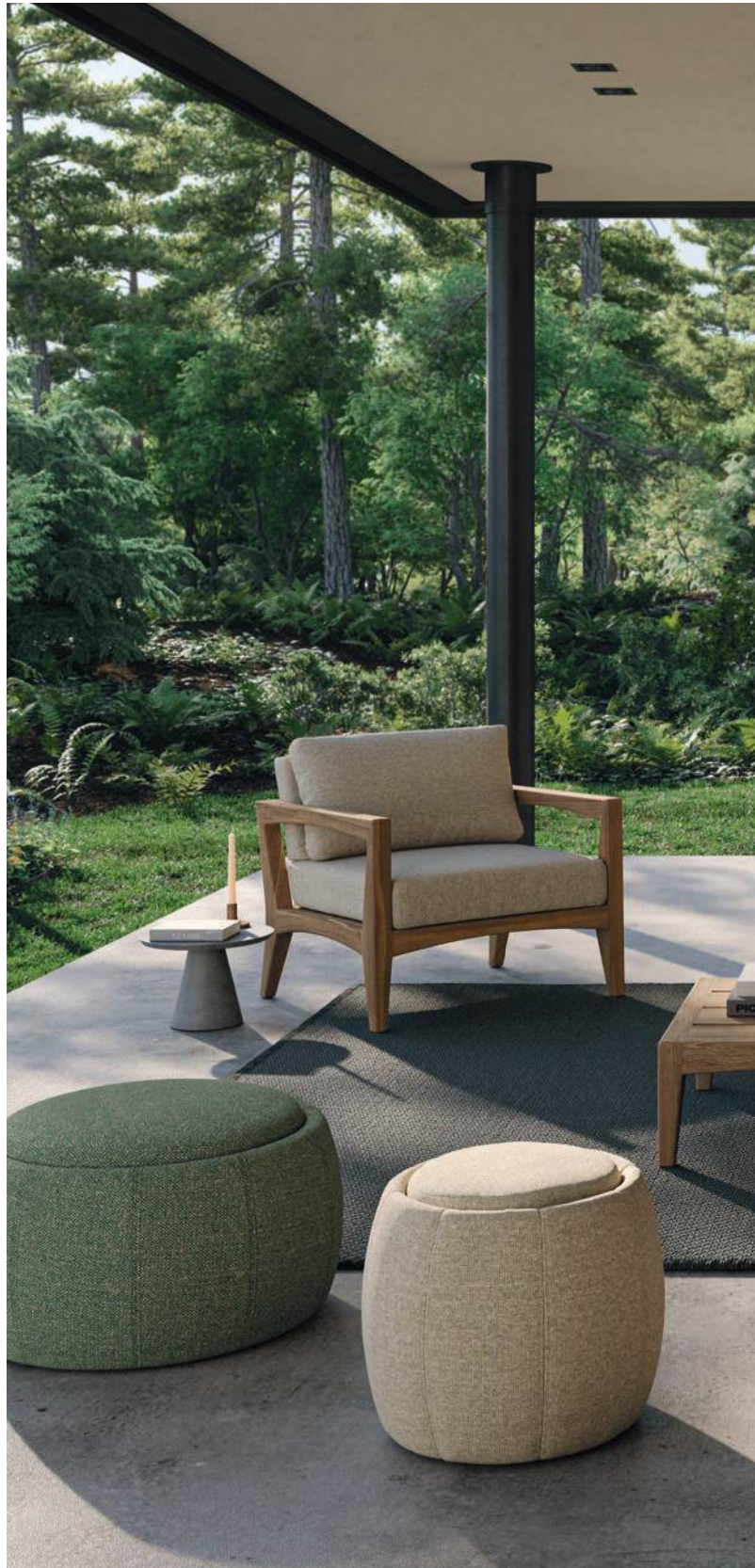













Alura Lounge



Archy Lounge



Calypso Lounge



Mambo Lounge



Mozaix Lounge (Teak)



Mozaix Lounge (Aluminium)



Ninix Lounge



Organix Lounge



Styletto Lounge



Zenhit Lounge

# Chairs



# Alura

The Alura Chair combines contemporary design with everyday practicality. Built from durable powder-coated aluminium, it offers exceptional stability while remaining lightweight and easy to handle. The chair's clean lines and refined proportions make it a natural fit for both residential and professional settings.

Stackable for convenient storage and easy to maintain, the Alura Chair is designed for effortless outdoor living. Optional teak armrests add a touch of warmth, bringing subtle contrast to its sleek, modern frame.









# Archy

The Archy Collection is defined by its sculptural sleeves that wrap gracefully around the tubular backrest. Each piece reflects meticulous craftsmanship and a sense of balance between structure and softness.

This year, the collection expands with a teak edition that translates the signature Archy design into solid wood, bringing a subtle warmth and a new material expression to the range. The aluminium version, with its Batyline seat, continues to embody lightness and precision. Both can be paired with cushions in a wide range of fabrics, adding comfort and depth to the design.

Expanding beyond the lounge and dining formats, the aluminium Archy also introduces a low dining chair, designed to pair effortlessly with lower tables for relaxed, informal gatherings.

Defined by clarity of form and enduring comfort, the Archy Collection embodies the timeless ease that characterises Royal Botania.

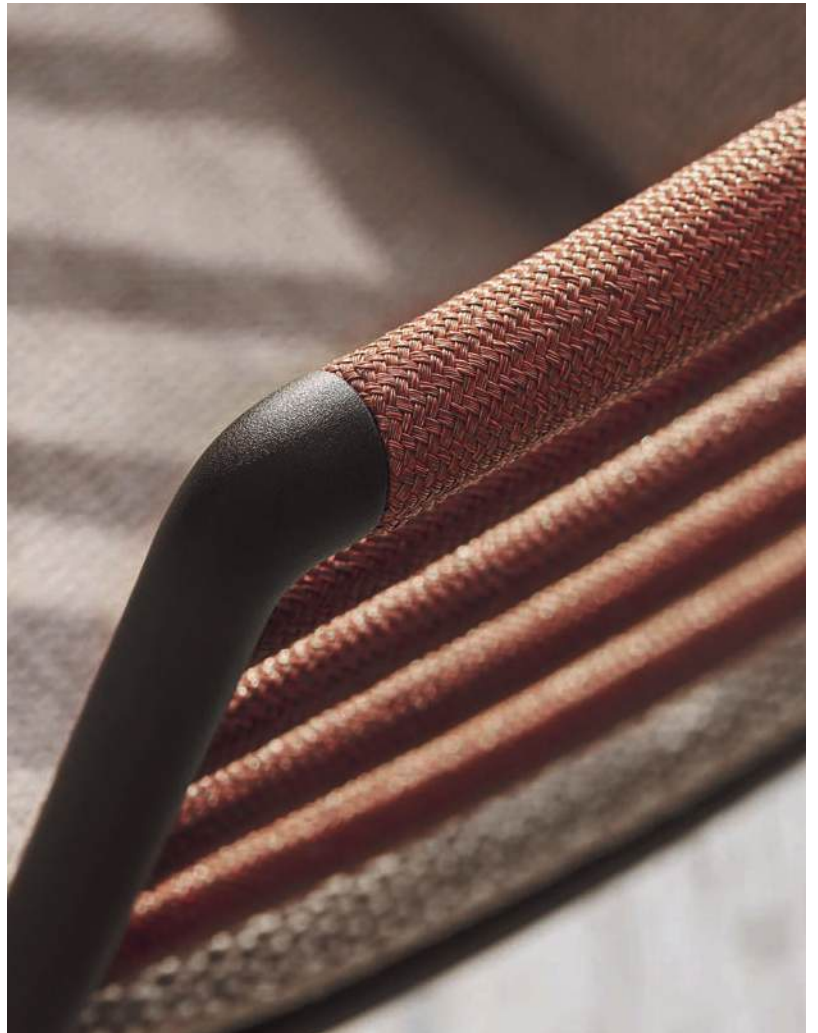



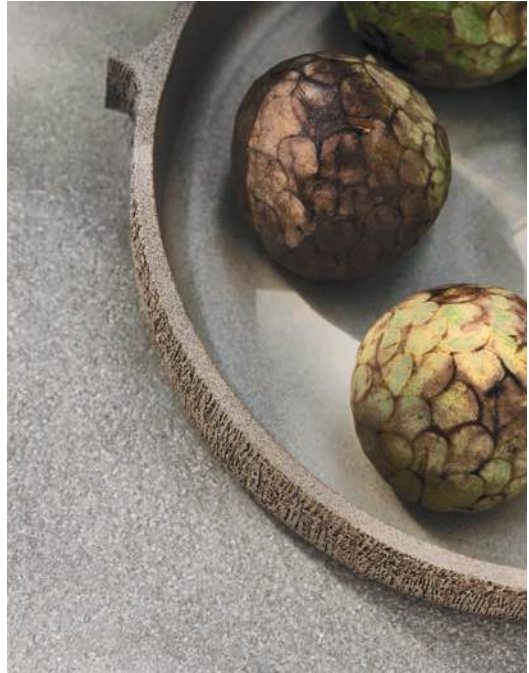



The Archy teak frame draws inspiration from the Vita collection, evolving into a softer, rounder design that captures the essence of modern outdoor comfort. Its refined curves bring a sense of warmth and ease, blending elegance with a contemporary aesthetic.

Rounded legs echo the smooth lines of the seating, creating a harmonious flow throughout. With modular seating and tables offered in six fiber colors and various tabletop materials, Archy makes it easy to personalize any outdoor space.









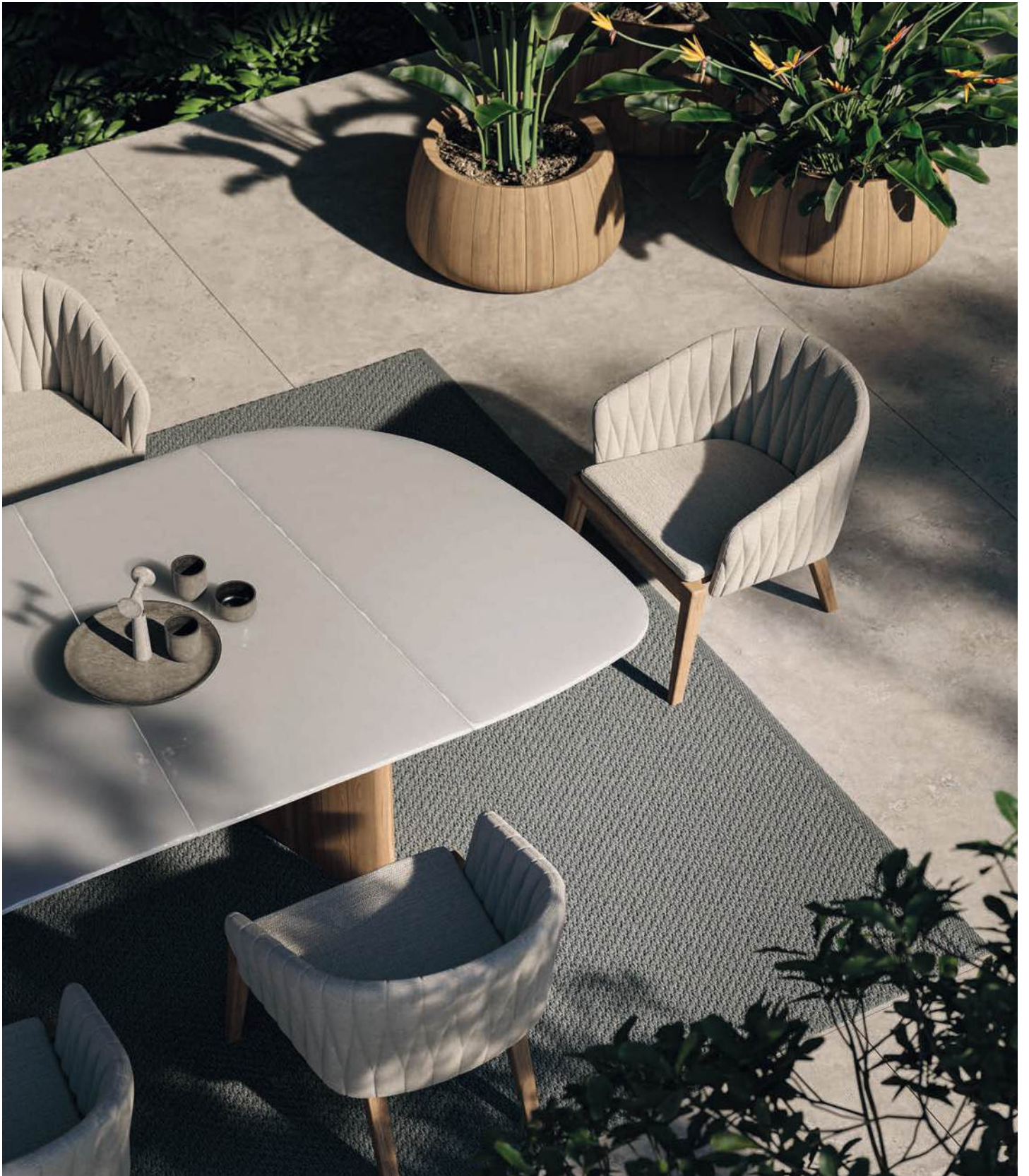

# Calypso

The Calypso Collection features a selection of outdoor seating options; each piece showcases a durable teak base paired with a stainless-steel backrest with padded upholstery.

These zip-on covers are designed for easy maintenance, simplifying cleaning and storage.

Available in a wide range of textiles, the collection offers extensive colour customization options to reflect any mood or style. Additionally, the collection features a “Kris Kross” weaving pattern, crafted from synthetic outdoor fibre, providing a choice between woven and textile backrests.









Designed by Kris Van Puyvelde, the Carés Collection captures the art of simplicity through refined lines and tactile contrasts. Its gently curved frame, available in natural teak or powder-coated aluminium, gives each piece a calm and balanced presence in any outdoor setting.

The hand-woven backrest adds depth and texture, available in Sage Green, Anthracite, brick or Pebble, subtle tones that harmonise beautifully with the frame's materiality. Alongside the dining and lounge models, the collection also includes a low lounge chair that extends the same elegant comfort to more relaxed settings.

# Carés







The ropes are hand-woven around a coated stainless-steel subframe that offers strength and stability while supporting the teak structure. Each fibre has a stretch-resistant polyester core and a UV-proof outer layer that repels water, helping the seat dry fast and stay refined.

Through its thoughtful mix of materials and craftsmanship, Carés carries a quiet sense of confidence. The design balances durability with tactile softness, remaining effortlessly timeless while maintaining its character with minimal care, season after season.



*Every Carés chair reveals its quality in the details. The solid teak frame is shaped with gentle curves and precise junctions, creating a smooth continuity between the seat and the flowing backrest. The hand-woven back adds warmth and texture, giving the design its distinctive depth and tactility.*





# Cordiz

The Cordiz Chair was born from a desire to create lightness in both form and function. We set out to design a chair that would feel effortless to move, comfortable to use, and strong enough to endure the elements.

That search led to a structure defined by precision and poise. A sleek stainless steel frame supports a solid teak seat, creating a refined contrast between warm natural wood and slender geometry. The use of stainless steel allows for an exceptionally thin silhouette that remains durable, stable, and stackable, combining practicality with elegance.

At the back, tensioned cords trace soft, geometric lines that bring both support and rhythm. The cords share the same advanced composition as those in the Carés Collection, featuring a stretch-resistant polyester core wrapped in a coloured, UV-proof layer that repels water and dries quickly. Combined with the teak seat slats and woven armrests, this interplay of materials brings warmth and tactility to its architectural form.



*Designed for everyday ease, Cordiz feels open, dynamic, and effortlessly at home in any setting.*



# Exes



A director's chair, reinterpreted with sculptural precision. Designed by Kris Van Puyvelde, the Exes Collection features bold X-shaped frames in cast aluminium. A striking geometry that conveys both strength and lightness.

Tapered teak armrests bring a natural warmth to the silhouette, balancing metal and wood in quiet harmony. The optional teak backrest and seat continue this dialogue of materials, while the distinctive X-shaped openings serve as discreet attachment points for cushions.

Defined by clarity of line and understated comfort, Exes offers a contemporary take on a classic form: refined, balanced, and built to endure. The collection is also available in a lower version, ideal for relaxed low dining settings.







# Folia

Derived from the Latin folium, meaning leaf, the Folia Collection takes its inspiration from the natural world and its effortless geometry. Just as a leaf balances strength and delicacy through its veins and curves, Folia translates this organic logic into a sculptural, architectural form.

The flowing lines of the stainless steel frame evoke movement and continuity, creating a design that feels both airy and precise. Its open pattern interacts beautifully with its surroundings, allowing light and shadow to play across the surface in ever-changing ways.

Available in a selection of subtle hues, each finish complements natural materials and outdoor settings with understated elegance. Whether paired with teak or ceramic tables, or standing alone as a statement piece, Folia captures the harmony between nature and design in its purest form.









*The collection extends beyond the dining chair to include a low dining chair and a rocking chair, designed for relaxed moments with family and friends. Whether enjoying a quiet morning coffee or lingering outdoors as the day slows down, these pieces create a setting where comfort and ease take over.*





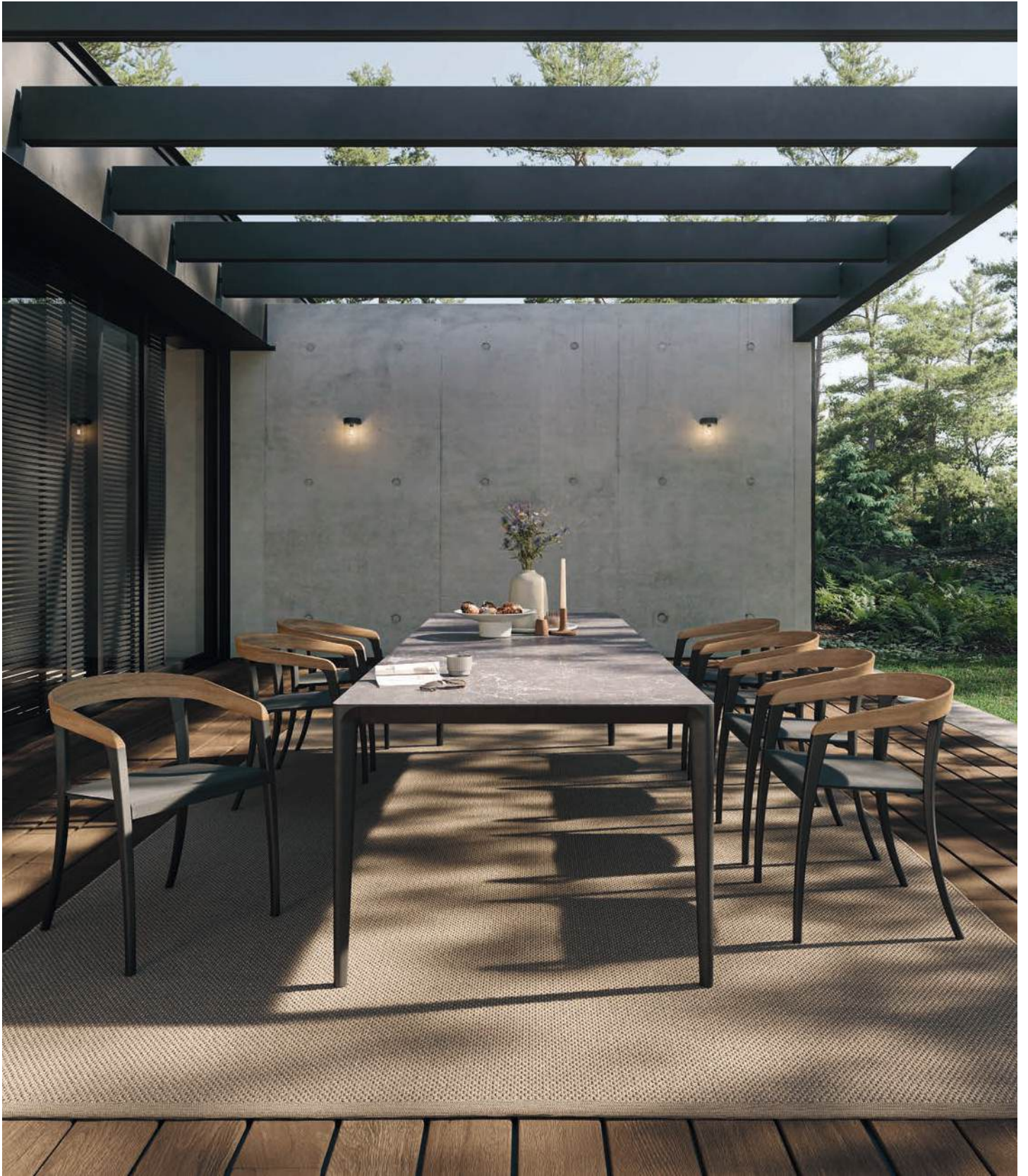

Discover the versatility of the Jive Collection, where chairs seamlessly blend into both modern and classic settings. Available in three unique material combinations, the Jive chair can be customized with either a teak or aluminum backrest, and the seat is offered in weaving, aluminum, or Batyline options. For added comfort, you can choose to add cushions, or opt for the sleek, cushion-free Batyline version, ensuring a perfect fit for your style and needs. Whether you're looking for functionality, elegance, or a mix of both, the Jive Collection adapts effortlessly to any space.



# Jive

*The Jive Chair exudes timeless elegance and effortless charm. Crafted with the meticulous attention to detail that defines Royal Botania, it combines refined proportions with enduring comfort. Its graceful silhouette brings harmony to any outdoor setting, from a sunlit terrace to the calm of a secluded garden. Built to withstand the elements while radiating sophistication, the Jive Chair is a celebration of craftsmanship, comfort and lasting beauty.*







# Mambo



Designed by Kris Van Puyvelde, the Mambo Chair and Mambo Low Chair offer a perfect balance of comfort and style. With their rounded teak frames and plush cushions, they bring a welcoming elegance to any outdoor setting. The Mambo Chair is ideal for dining, while the Mambo Low Chair offers a more relaxed, lounge-like experience. Both can be customized with luxurious fabrics, ensuring they perfectly match your personal aesthetic.

Unlike the Mambo Lounge, which features an internal stainless steel structure for added support, the Mambo Chair and Mambo Low Chair rely entirely on the natural strength and refinement of solid teak. Their gracefully curved armrests, slender legs, and inviting cushions create a look of effortless lightness and timeless sophistication.









For over two decades, the Ninix Chair embodies refined minimalism and enduring craftsmanship. Its sleek lines and balanced proportions express timeless elegance, while premium materials ensure lasting performance in any environment.

Crafted with precision, the chair features a stainless steel frame with optional teak armrests, seamlessly paired with Batyline for optimal comfort and durability.

A lasting icon of modern outdoor design, the Ninix Chair brings understated luxury and everyday ease to any setting, season after season.



# Ninix



# Ostrea

The Ostrea Chair embodies the refined simplicity of the sea. Named after the Latin word for “oyster”, it reflects designer Mathias De Ferm’s creative vision through fluid contours and meticulous craftsmanship. Each stainless steel tube is precisely rolled, bent, and welded, revealing the sculptural quality of true craftsmanship.

The collection offers two cushion styles: a rounded seat that leaves the curved back elegantly exposed, or full padding that follows the organic shape of the oyster.









The O-Zon Chair embodies sculptural elegance shaped for everyday life. Its slender frame, crafted from stainless steel or coated aluminium, expresses both strength and refinement. Designed to be stackable, it moves effortlessly between settings, from an intimate terrace to a lively dining area, while maintaining its crisp, contemporary character.

# O-zon



# Strappy

In designing the Strappy Collection, Kris Van Puyvelde reimagined outdoor seating with sleek lines and precision of detail. The collection's signature straps, elegantly wrapped around the frame, create a distinctive aesthetic while ensuring resilience and comfort, no matter the weather.

Crafted from premium materials, the Strappy Collection balances lightweight elegance with lasting durability. The sleeves, available in a range of refined finishes, offers the flexibility to customize each piece to perfectly complement your outdoor space. Whether grouped around a dining table or used as standalone seating, the Strappy Collection integrates seamlessly into any setting.







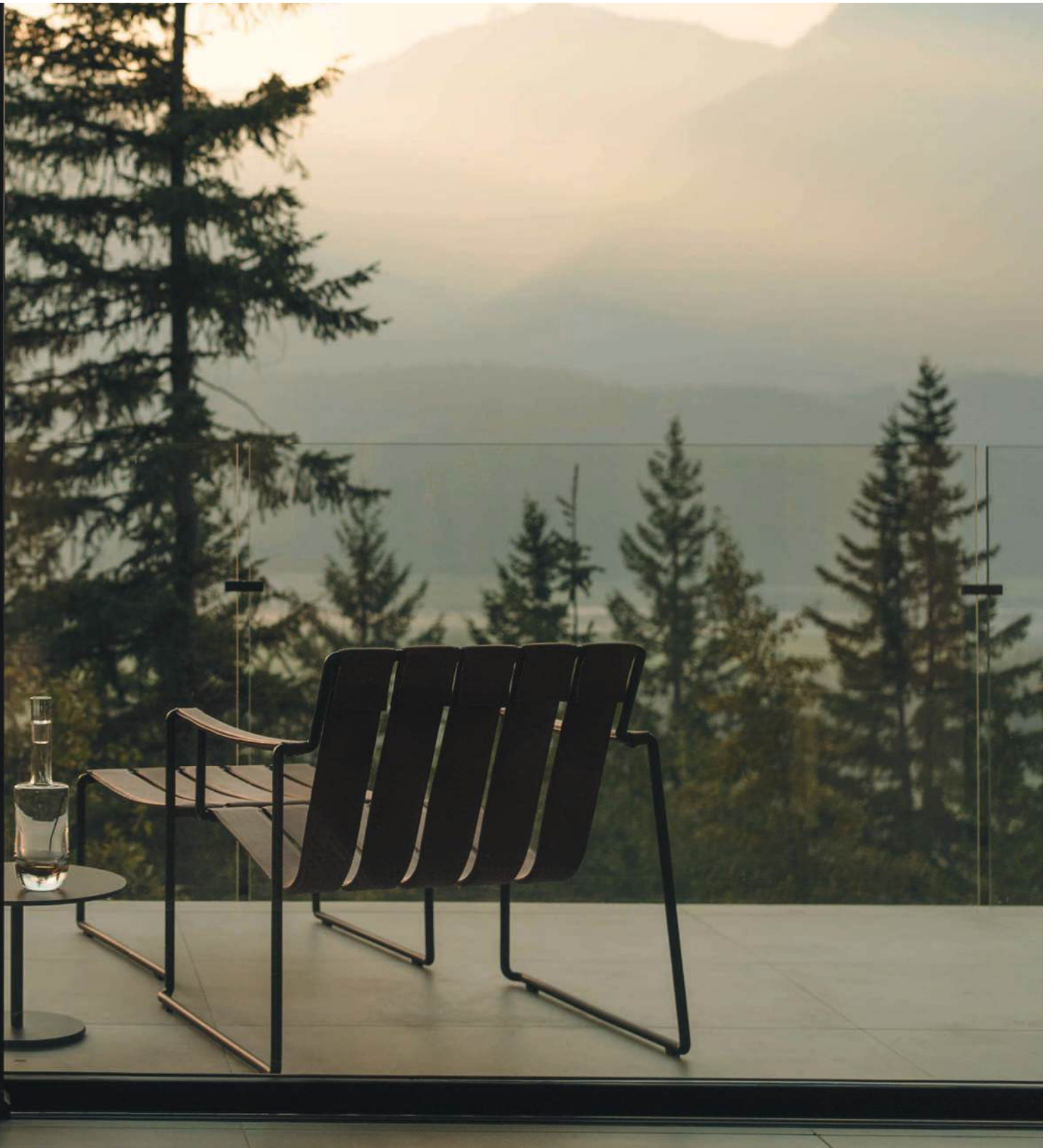



*Extending the concept, the Strappy Lounge Chair and Strappy Rocking Chair offer a lower, more relaxed seating position, translating the collection's signature design language into a piece made for unwinding.*

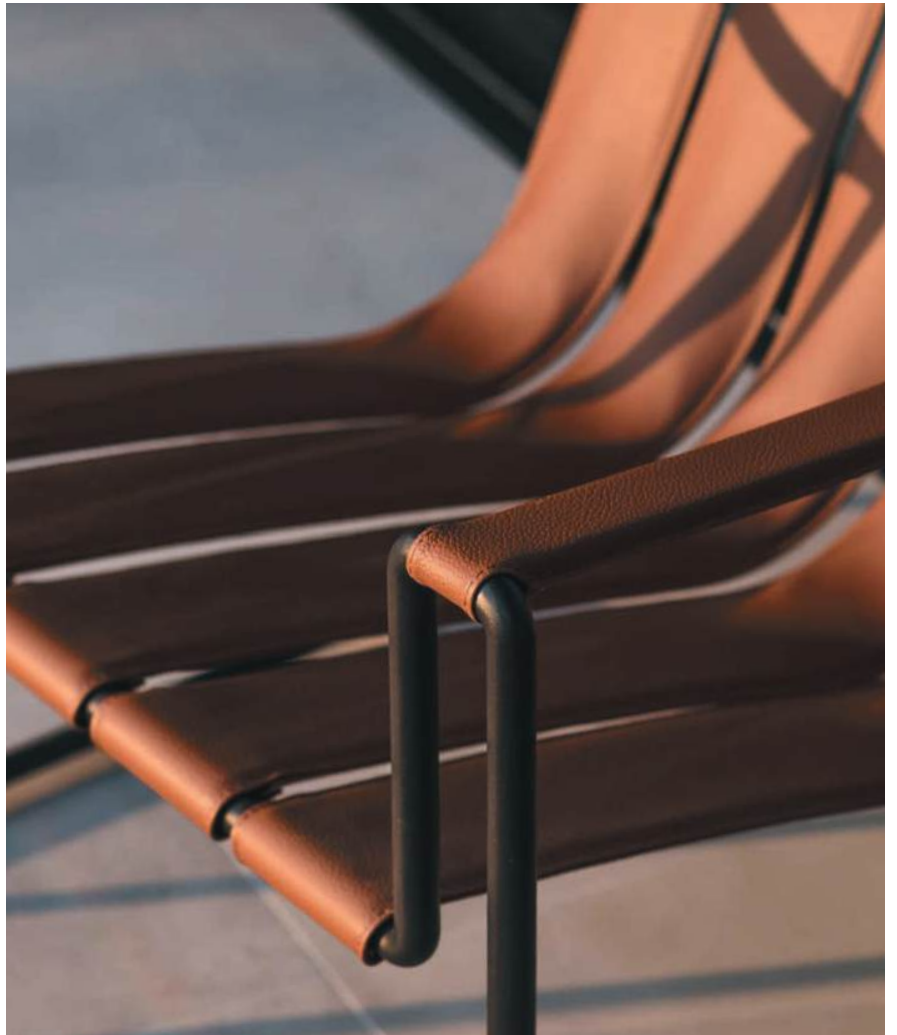





# Stiletto



As its name suggests, the Stiletto Chair stands with the same poise and elegance as a fine stiletto heel. Its slender, tapered legs give the design a graceful silhouette, while the precise geometry brings balance and composure to any setting.

Built on a lightweight aluminium frame, it combines strength with versatility through a modular seat system, quick-drying cushions and a practical snap-on backrest. The result is a design that feels effortlessly light, inviting, and enduring. A chair made for refined outdoor living.









Crafted from the finest teak, the Zenhit carver and Low Chair embody both durability and timeless elegance. Their modest yet sophisticated design complements any outdoor setting, offering a refined balance of comfort and style.

With clean lines and exceptional craftsmanship, these chairs provide a seamless addition to your outdoor space, making them ideal for both dining and lounging. An additional aluminum plate discreetly integrated into the back cushion enhances comfort and support, ensuring an even more enjoyable seating experience.



# Zenhit







Alura Dining Chair



Alura Dining Chair



Alura Low Chair



Alura Footrest



Alura Bar Chair



Archy Dining Chair



Archy Dining Chair



Archy Low Chair



Calypso Dining Chair



Calypso Low Chair



Calypso Bench



Calypso Bench



Calypso Bar Chair



Carès Dining Chair



Carès Low Chair



Cordiz Dining Chair



Exes Dining Chair



Exes Dining Chair



Exes Low Chair



Folia Dining Chair



Folia Low Chair



Folia Rocking Chair



Folia Footrest



Jive Dining Chair



Jive Dining Chair



Jive Dining Chair



Jive Low Chair



Mambo Dining Chair



Mambo Low Chair



Ninix Dining Chair



Ninix Low Chair



Ninix Bar Chair



Ninix Relax Chair



Ninix Footrest



Ostrea Dining Chair



Ostrea Low Chair



Ostrea Bar Chair



O-zon Dining Chair



O-zon Dining Chair



O-zon Bar Chair



Strappy Dining Chair



Strappy Low Chair



Strappy Rocking Chair



Strappy Footrest



Styletto Dining Chair



Styletto Bar Chair



Zenhit Dining Chair



Zenhit Low Chair

# Tables





# Butler

The Butler Collection is defined by its refined simplicity and versatility. Each table rests on a slender coated stainless steel base with a central column design that fits seamlessly into any terrace setting, from compact side tables to spacious dining tables.

A wide choice of tabletops, available in ceramic, enamelled lava stone, cast glass or teak, allows for harmony in both tone and texture.

At the heart of the collection, the Butler dining table combines elegance with practicality. Its central base maximizes legroom and comfort, offering a perfectly balanced design that brings quiet coherence to any outdoor space.









# Conix

The Conix Table Collection reveals a clear architectural language through its sculptural, conical bases cast in fibre-reinforced Ductal® concrete. These solid forms are available in two tones: a warm desert beige that softens the space, and a cool industrial grey that adds a contemporary edge.

A range of tabletop shapes, including the signature squircle, introduces subtle movement and visual rhythm. Offered in multiple heights, the Conix tables adapt effortlessly to different settings, from intimate lounge arrangements to generous dining compositions.

Defined by durable materials and refined geometry, the collection brings structure and serenity to both outdoor and indoor environments.

The Conix Side Table captures the collection's sculptural spirit in a compact form. Tabletops are available in lava stone, ceramic, concrete or teak, each material adding its own texture and tone.









# Exes

Complementing the Exes chairs, the tables in the collection feature the same distinctive X-shaped leg design. A sculptural tripod for the round models and a four-legged frame for the oval versions. Each piece reflects the collection's architectural coherence, translating the graphic interplay of lines into a solid yet refined structure.

Available in a curated selection of ceramic finishes and teak tops, the Exes tables integrate effortlessly into contemporary environments. Whether placed indoors or outdoors, they bring a sense of balance and precision that defines the Exes Collection's modern character.





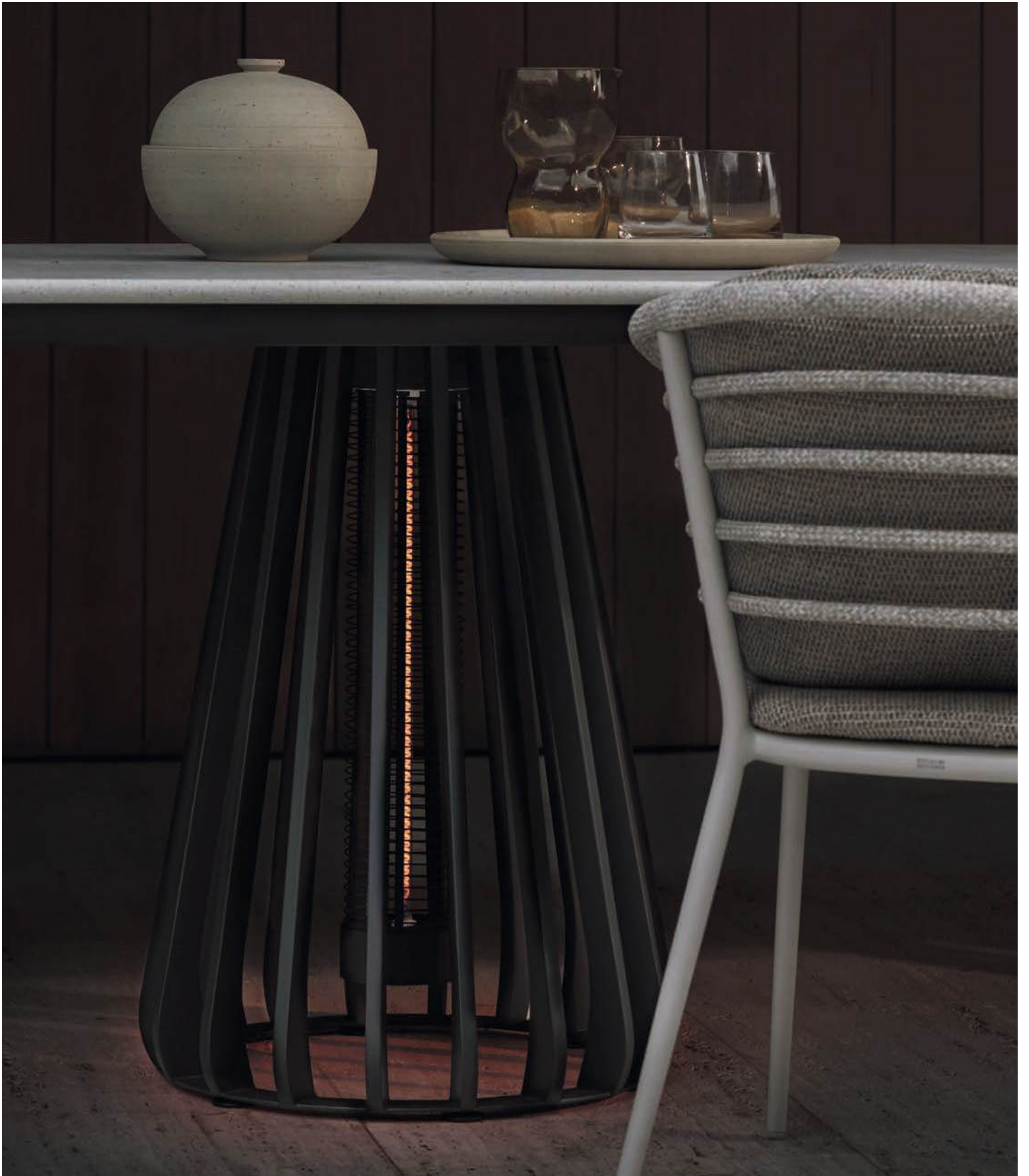

# Furniz

At its core lies a central column that not only supports the table but also neatly houses the electric cable, ensuring a clean and refined appearance. In warmer months, this column can easily be replaced with a complementary version without wiring, allowing the table to adapt seamlessly to every season.

Conceived as furniture that can serve as a furnace, the Furniz Table merges comfort, innovation, and design excellence to redefine the concept of outdoor living.



reddot winner 2025





*The Furniz table combines elegant design with discreet functionality. The single base model integrates a 2000 W infrared heating element, while the dual base versions feature two 1600 W elements, providing instant warmth at the touch of a hidden switch beneath the tabletop.*

*In warmer months, the cable column can easily be replaced with a complementary version without wiring, allowing the table to adapt seamlessly to every season. Its intelligent design and refined detailing were recognised with a Red Dot Design Award.*







*By lowering the table height, Furniz softens the boundary between lounging and dining, creating a setting where time stretches and conversation flows.*

*It encourages an unhurried rhythm, dinners that flow into late evenings, moments that feel spontaneous yet composed. Low dining transforms outdoor living into a more intimate and grounded experience, where comfort defines the pace.*

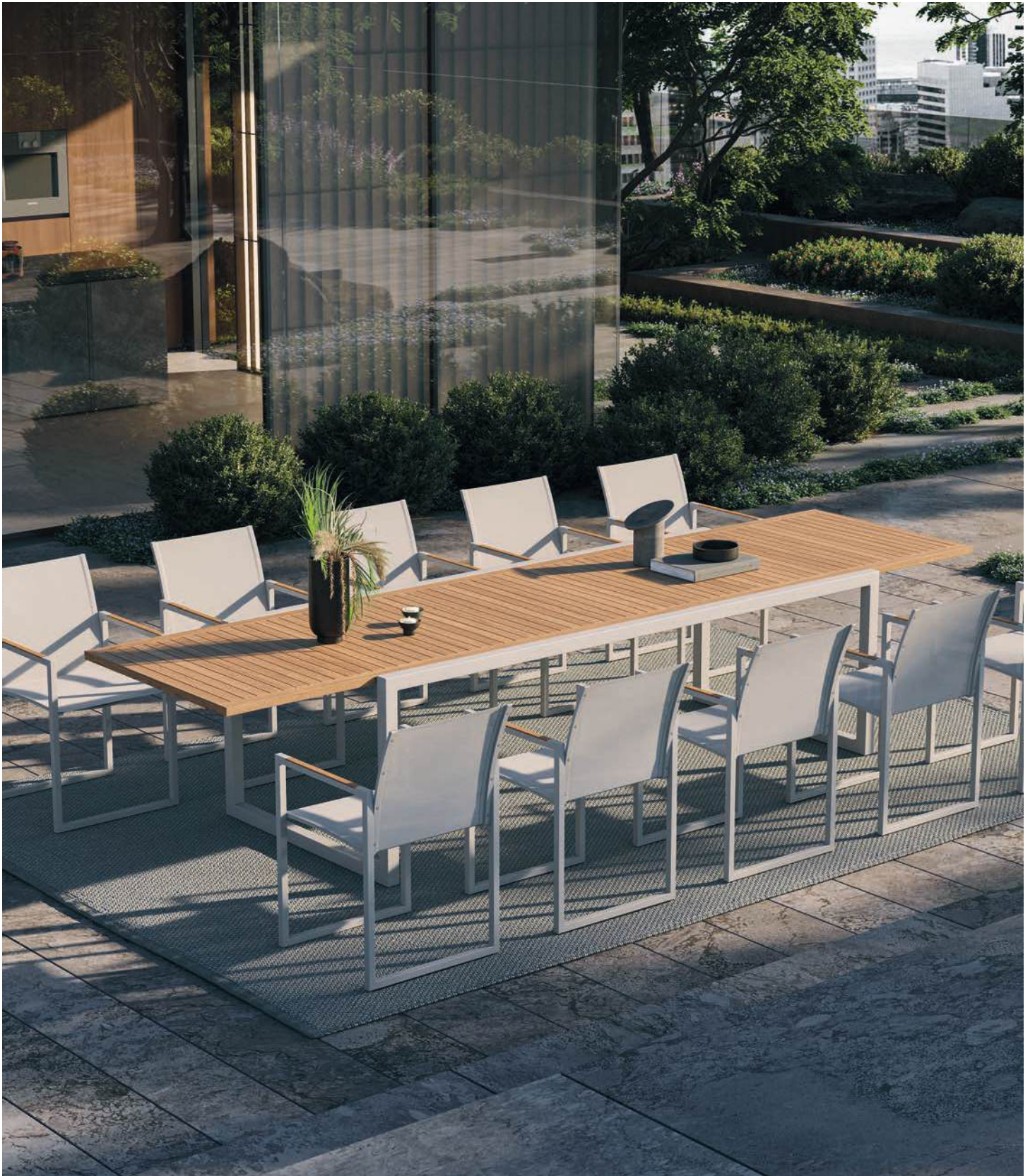

# Ninix

The Ninix tables feature a sleek, minimalist design with a frame crafted from brushed or coated stainless steel. The tabletops are available in either teak or ceramic, allowing you to choose the look that suits your space. For added versatility, the Ninix range includes an extendable version, perfect for accommodating larger gatherings while maintaining its modern, streamlined aesthetic.

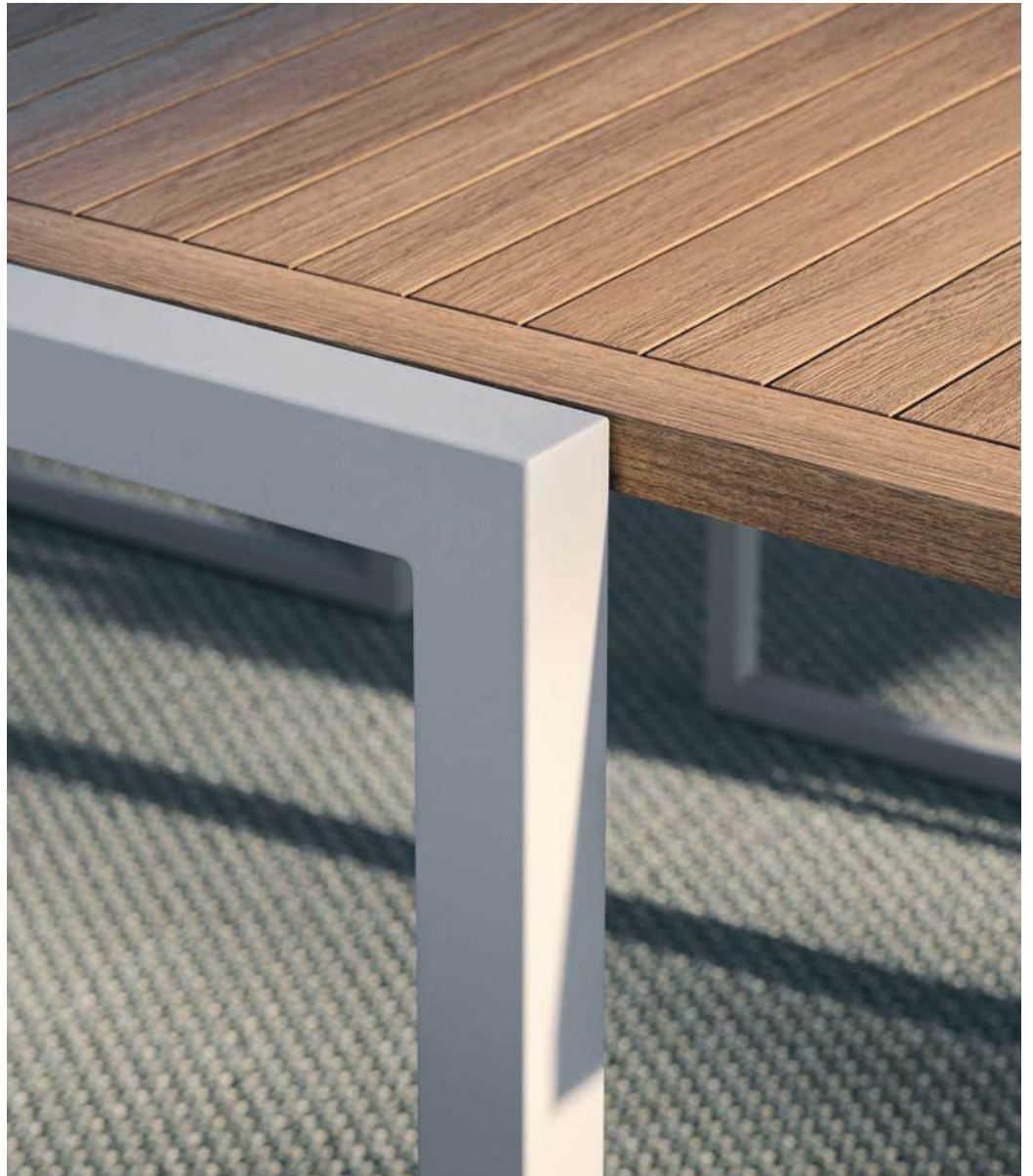

# Styiletto

With its slender, tapered legs and sculptural balance, the Styiletto Table brings architectural elegance to outdoor living. Available with either aluminium or solid teak legs, it offers a choice between a sleek contemporary look and a warmer, more natural expression. The design combines visual lightness with remarkable strength, creating a table that feels both refined and enduring.

Offered in a wide range of heights, shapes and finishes, the Styiletto Table adapts naturally from intimate lounge settings to generous dining arrangements. Every detail reflects precision and craftsmanship, from the seamless junctions to the rich combination of materials. The result is a piece that complements any outdoor environment with timeless elegance.





The new super ellipse tabletop introduces a gentle evolution in form. Its softened geometry bridges the precision of a rectangle and the fluidity of an oval, resulting in a shape that feels balanced and natural from every angle.



Designed to complement any Royal Botania table base, the super ellipse creates visual harmony across all collections. In sienna arena ceramic, the surface highlights the subtle contour of the edge, revealing both craftsmanship and material depth.





# Regaliz

Designed by Kris Van Puyvelde and honoured with a Red Dot Design Award for Product Design, the Regaliz Table stands as the epitome of outdoor luxury. Its sculptural oval teak bases support a range of tabletops in glass, ceramic, or enamelled lava stone. The glass version, crafted with a special melting technique, comes in distinctive finishes such as dark green, dark brown, and pebble, while the lava stone is available in a refined palette of colours that highlight the material's natural depth and texture.

Available in sizes ranging from 310 to 490 cm, the table's modular design features trapezium-shaped sections that combine grandeur with flexibility. While conceived for outdoor living, the Regaliz Table's sophisticated presence and material richness make it equally at home in an elegant indoor setting.

With its exceptional design and innovative craftsmanship, the Regaliz Table embodies refined strength and effortless elegance, becoming the natural centrepiece of any distinguished environment.



reddot winner 2025





Once cut and shaped to perfection, the glass is placed on a textured mould and gently reheated to its melting point. During this stage, the underside takes on the relief of the surface beneath, while the top develops its signature organic waves.



After cooling, the glass is coated in deep forest green, rich brown or soft pebble tones, then tempered and carefully polished. The result is a surface of remarkable depth and character, a true visual delight.









Carefully selected slabs of lava stone, sourced from volcanic eruptions around Mount Vesuvius and Sicily, are coated with a fine layer of enamel and fired at 950°C. During this intense process, each piece develops its own unique surface texture and tonal variation. No two slabs emerge exactly alike, and when combined into a single tabletop, their subtle differences create a rich, natural composition. The result is a surface of exceptional depth and beauty.











*Following the instant success of our award-winning sectional Regaliz table, a new round version has been introduced, crafted entirely from solid teak. This design brings a softer, more organic expression to the collection, highlighting the warmth and natural beauty of the wood. Its round form invites connection and conversation, becoming an elegant focal point for relaxed outdoor dining.*

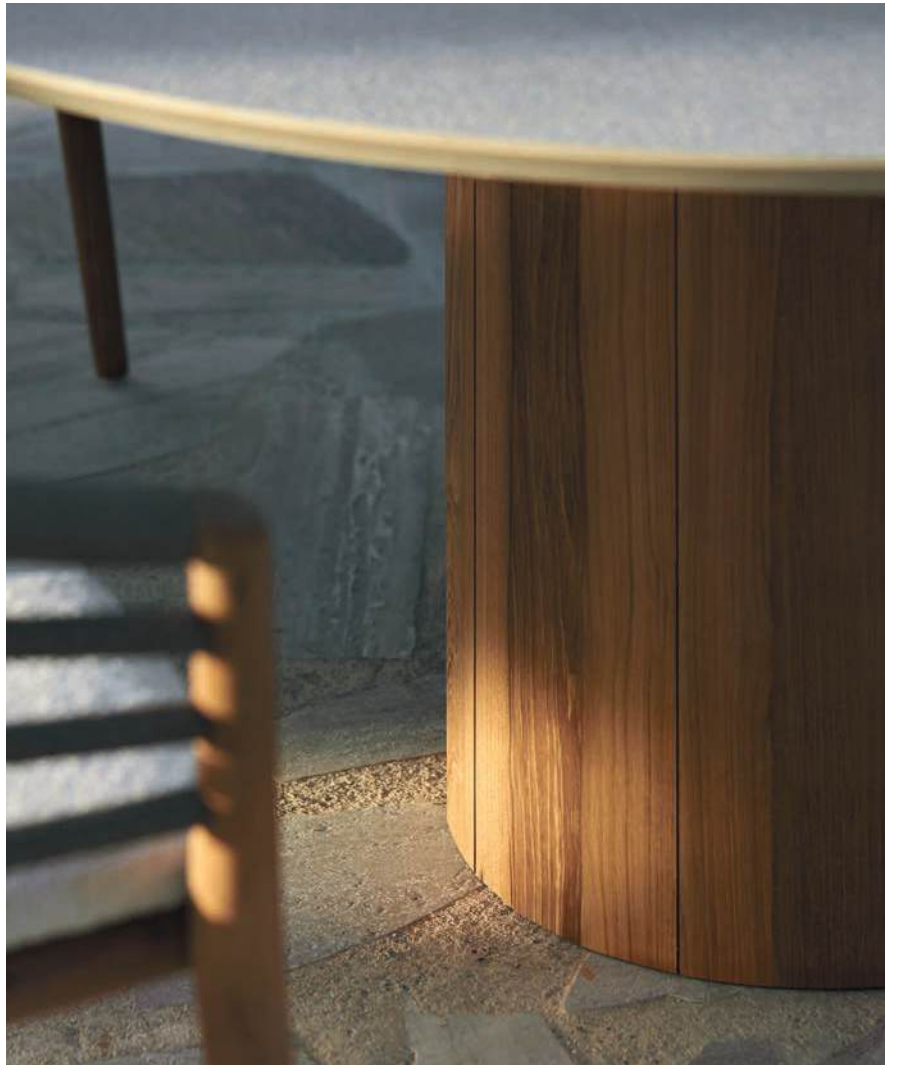

# U-nite

The U-Nite collection is defined by its architectural clarity and inviting materiality. Each table features a teak or powder-coated aluminium frame paired with a floating tabletop in ceramic or teak. The ceramic versions fit precisely within the frame thanks to their angled edge, creating a sleek and cohesive surface.

Available in multiple sizes and shapes, the U-Nite collection brings a sense of order and refinement to contemporary outdoor dining environments.















# Traverse

Inspired by the classic English gate-leg table, designer Mathias De Ferm reimagines the concept with the Traverse Table, bringing together practical innovation and contemporary design. Its flexible structure allows it to be used partially open for a brief coffee or an intimate meal or fully extended to host a larger setting.

An intuitive sliding support system and a slim silhouette when folded make the Traverse an ideal choice for adaptable, design-driven outdoor spaces.



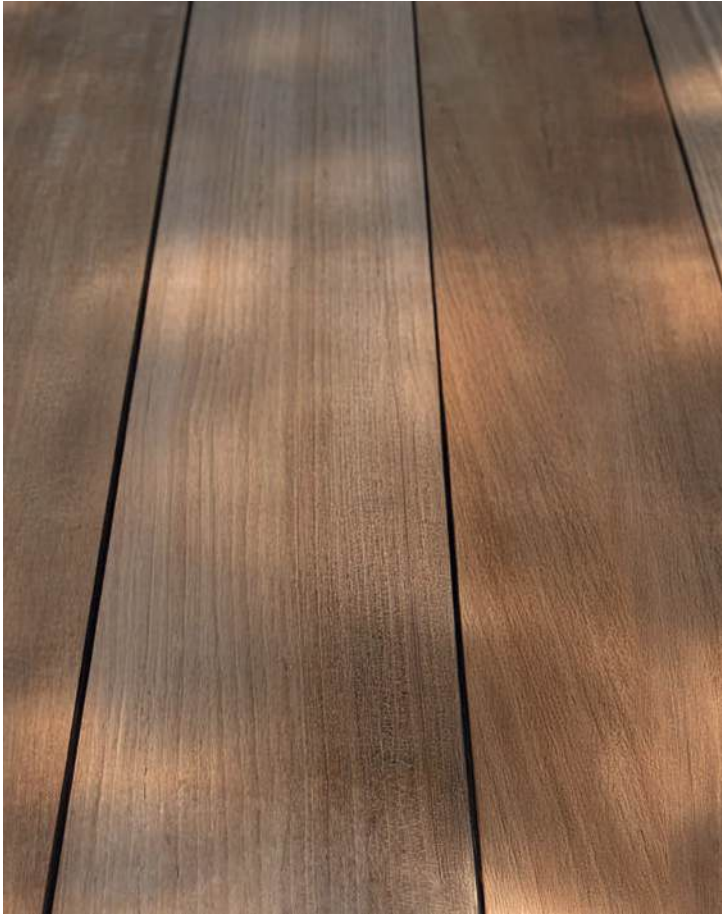

This collection stands out for its craftsmanship, expressed through large, beautifully profiled wooden slats made from premium teak. The precision of the joinery and the depth of the wood grain give each tabletop a unique, tactile character. A hallmark of the Zidiz Collection.

A defining example is the extendable ZIDIZ 320 table, whose length adjusts smoothly from 220 to 320 cm. Designed with both elegance and ease of use in mind, it adapts effortlessly to different occasions while maintaining the natural refinement that defines the collection.

# Zidiz

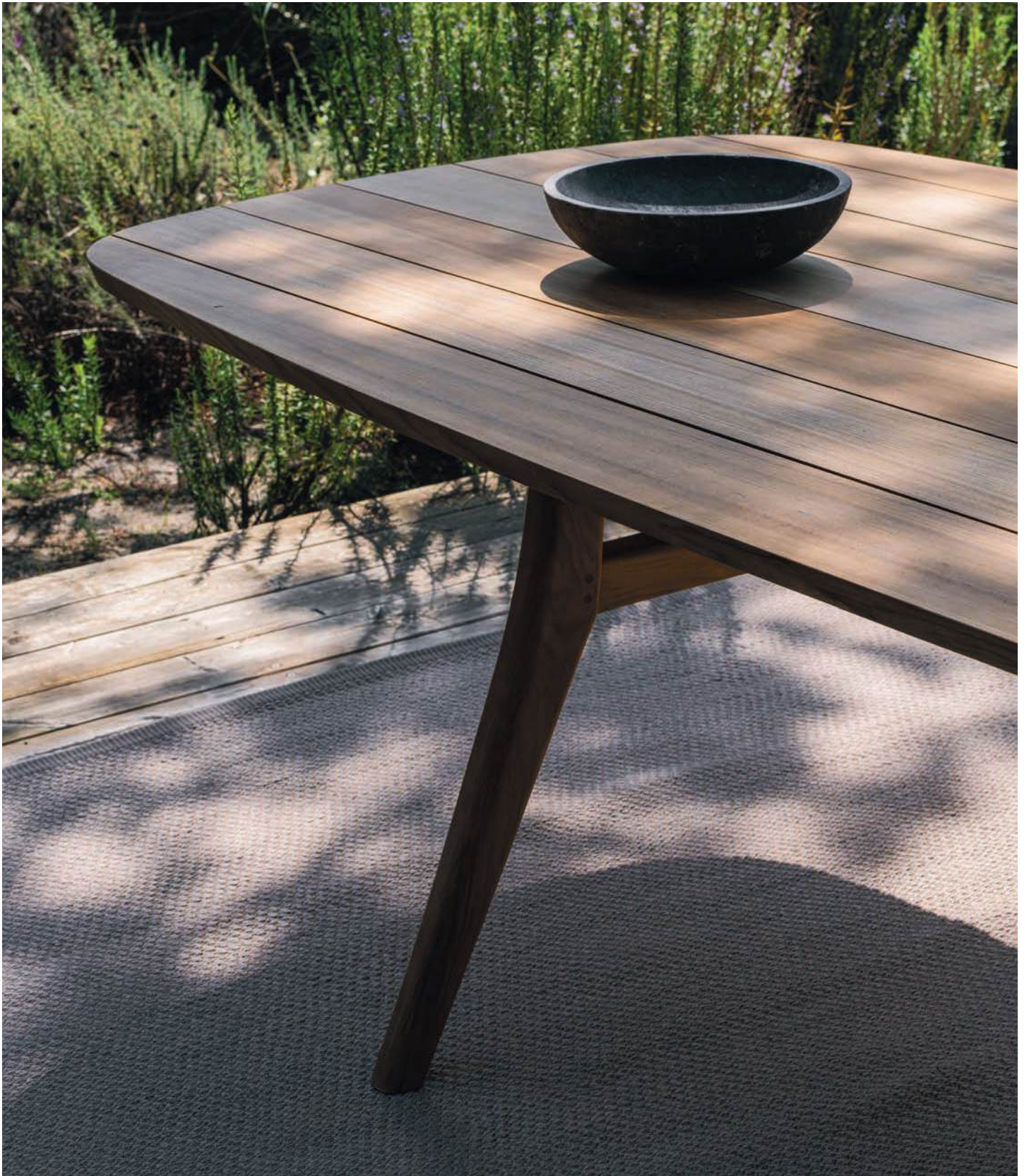







Butler 40 Side Table



Butler 60 Side Table



Butler 90 Dining Table



Butler 120 Dining Table



Conix 40 Side Table



Conix 60 Side Table



Conix 160 Dining Table



Conix 150 Dining Table



Conix 220 Dining Table



Conix 2513 Dining Table



Exes 120 Dining Table



Exes 160 Dining Table



Exes 220 Dining Table



Exes 2512 Dining Table



Furniz 160 Dining Table



Furniz 150PL Dining Table



Furniz 3214 Dining Table



Furniz 2512 Dining Table



Ninix 90 Side Table



Ninix 90T Side Table



Ninix 150T Side Table



Ninix 200 Dining Table



Ninix 270 Dining Table



Ninix 360 Dining Table



Regaliz 3113 Dining Table



Regaliz 3713 Dining Table



Regaliz 4313 Dining Table



Regaliz 4913 Dining Table



Regaliz 220 Dining Table



Regaliz 3214 Dining Table



Regaliz 120 Dining Table



Regaliz 160 Dining Table



Regaliz 2512 Dining Table



Regaliz 300 Dining Table



Styletto 40 Side Table



Styletto 60 Side Table



Styletto 120 Bar Table



Styletto 160 Dining Table



Styletto 220 Dining Table



Styletto 3214 Dining Table



Traverse 130 Dining Table



Traverse 130 Dining Table



U-nite 160 Dining Table



U-nite 150 Dining Table



U-nite 220 Dining Table



U-nite 300 Dining Table



Zidiz 2512 Dining Table



Zidiz 320 Dining Table

# Sun Loungers





# Alura

The Alura Sunlounger expresses comfort through intelligent design. Its patented reclining system, discreetly integrated into the rear leg, allows the lounger to adjust in one fluid movement, finding the perfect balance between support and ease.

Defined by sleek lines and a lightweight frame, it invites you to relax with effortless grace. Durable materials and precise detailing ensure lasting comfort and timeless appeal, season after season.



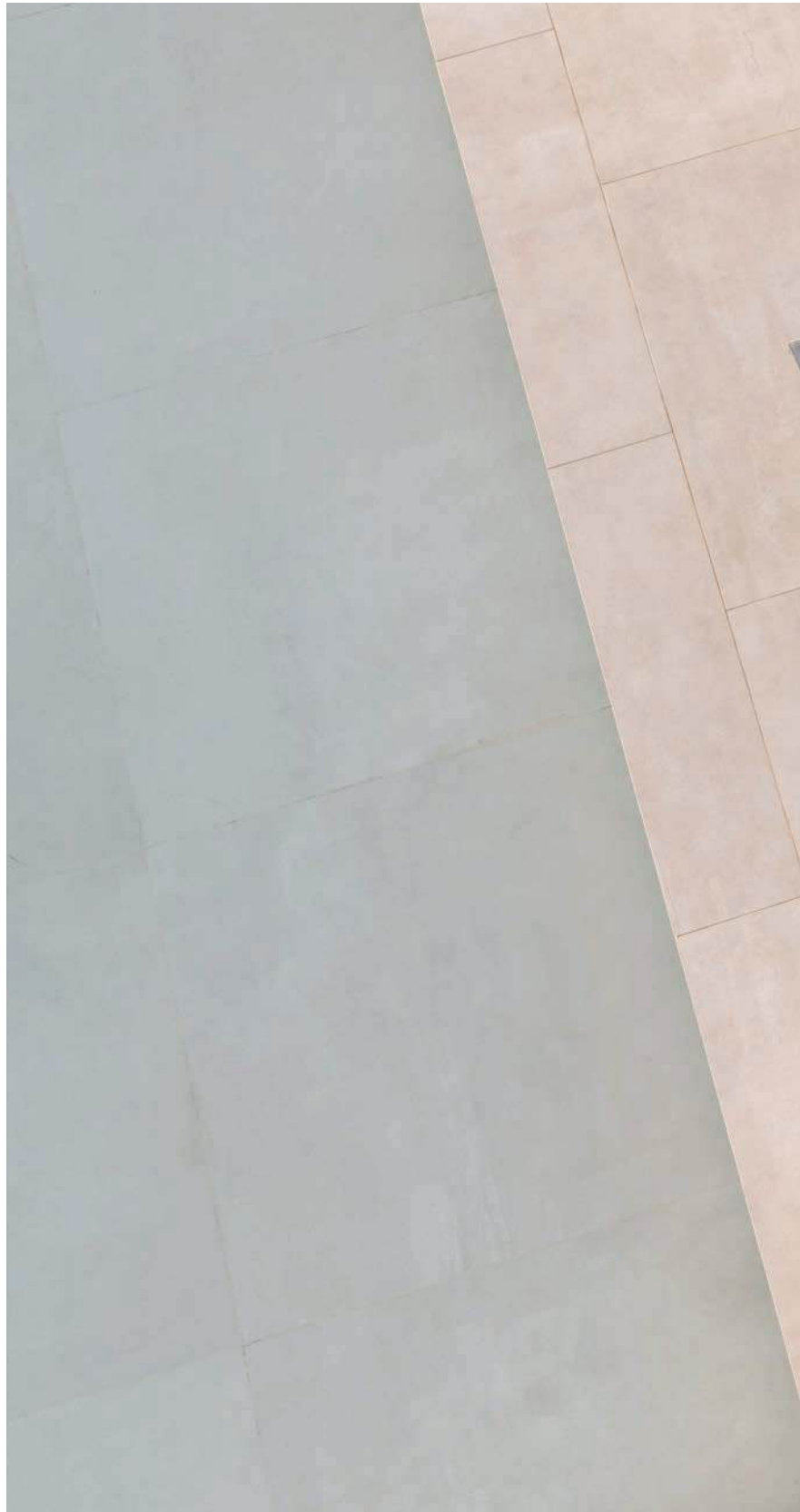







# Ninix

The Ninix Sunlounger has become a true design classic within the Royal Botania collection. For years it stood as our best-selling piece by far, and it remains an evergreen in our range, gracing luxury terraces, yachts and hotels across the world.

Its sleek lines, intelligent construction and exceptional comfort embody the perfect balance between minimalism and precision that defines our design language. As the world's first outdoor lounge with gas spring operation, it set a new standard for effortless adjustability and comfort.

Crafted from premium materials, the lounge combines durability with refined elegance, making it equally suited to private retreats and prestigious hospitality spaces. As one of Royal Botania's most recognisable icons, the Ninix continues to represent the essence of modern outdoor living: timeless, functional and effortlessly sophisticated.





# O-zon

The O-Zon Collection embodies lightness, precision and contemporary comfort. Its sculptural lines and slender frames bring a refined simplicity to any setting, combining strength with effortless ease. Designed to endure, O-Zon seamlessly transitions from private gardens to prestigious projects around the world.

A recent highlight is its presence aboard the remarkable mega yacht Here Comes The Sun, created in partnership with ECC. On deck, the O-Zon chairs and loungers enhance the yacht's serene atmosphere, offering guests a place to unwind in comfort while surrounded by the calm of the open sea. Their sleek silhouettes and durable craftsmanship perfectly complement the vessel's spirit of elegance and performance.



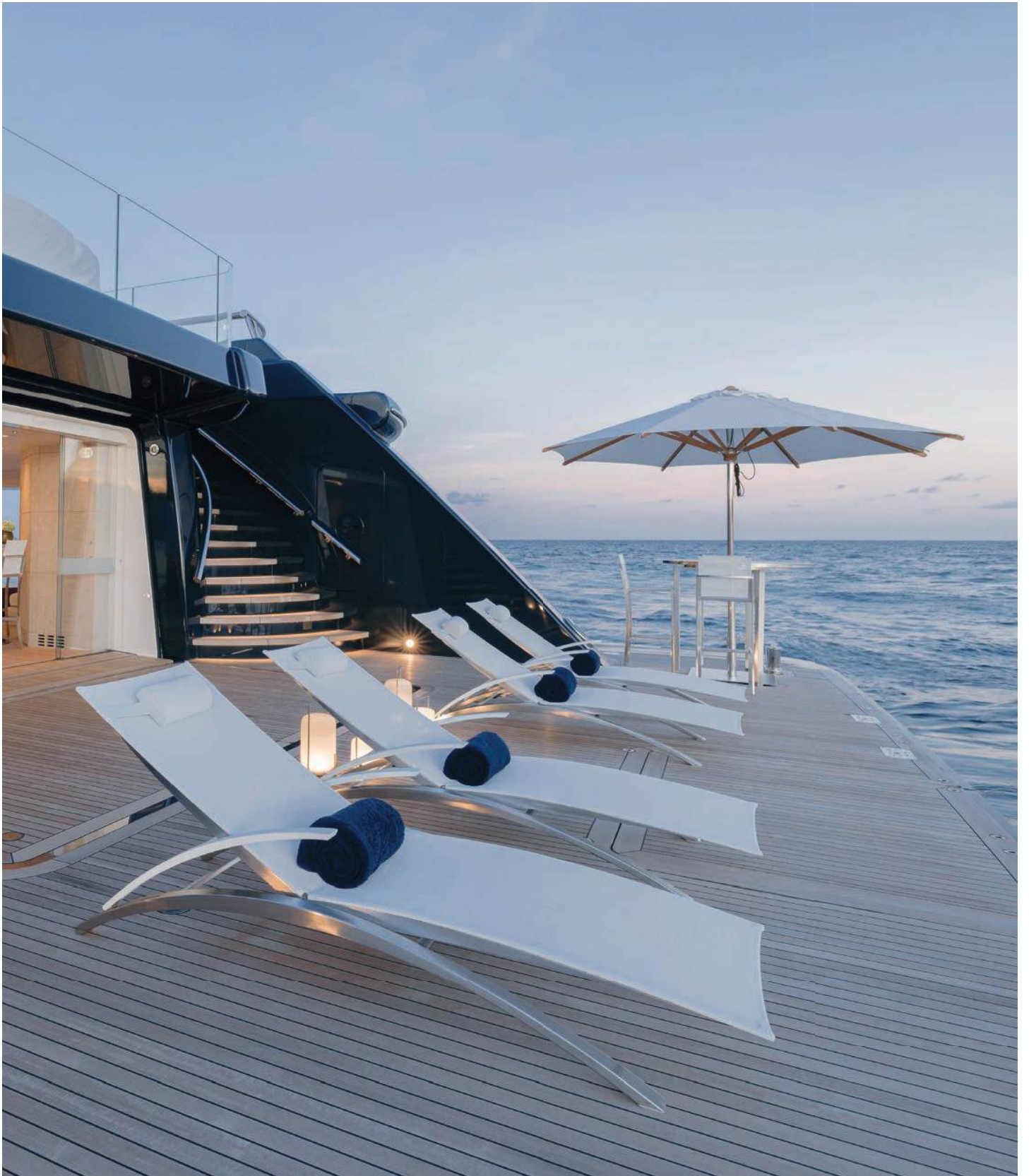



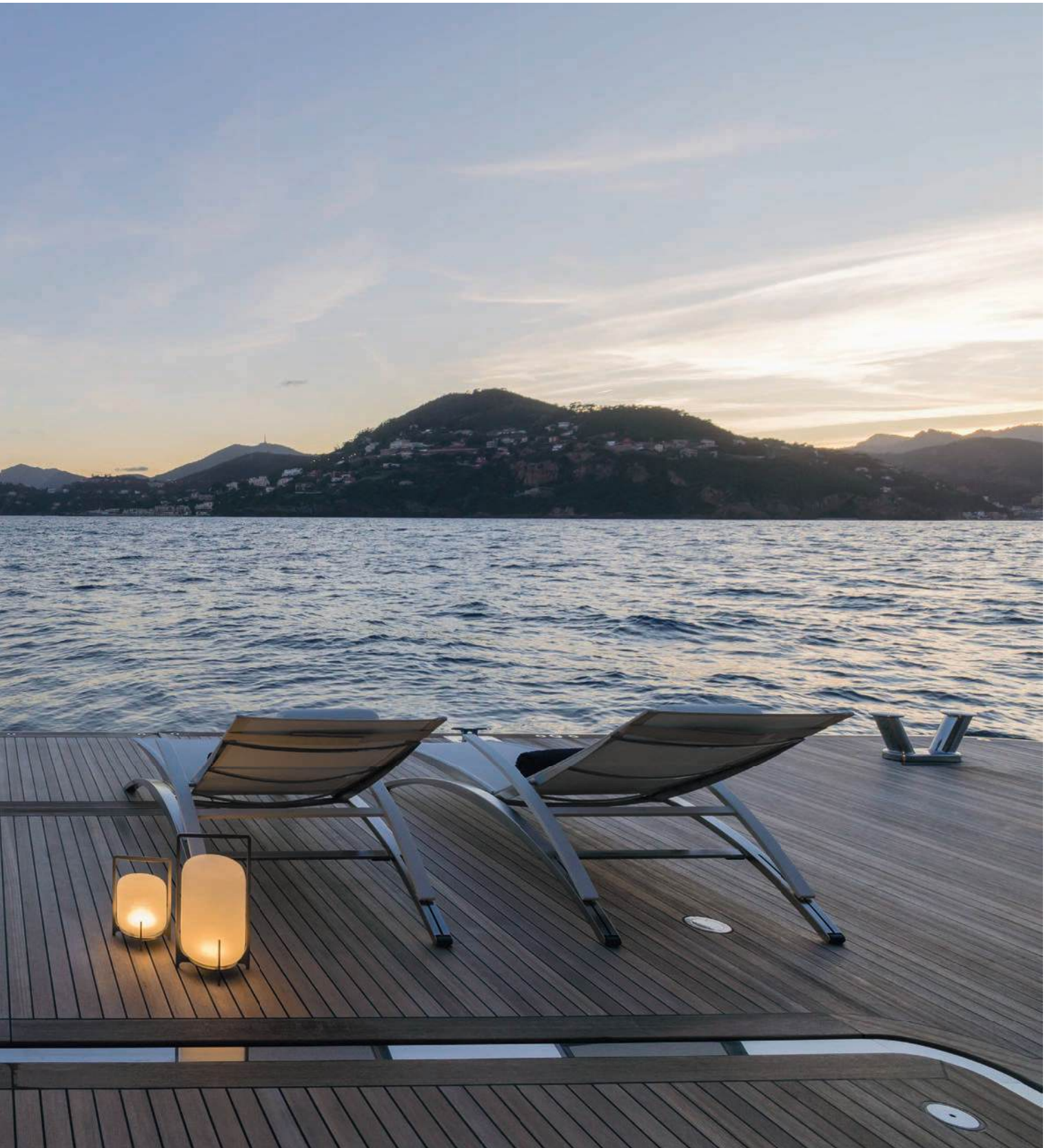

# QT

The QT lounge is defined by its minimalist silhouette and precision in form. Its slim yet solid stainless steel frame reflects both strength and restraint, offering lasting comfort in a design that feels light and effortless.





# Strappy

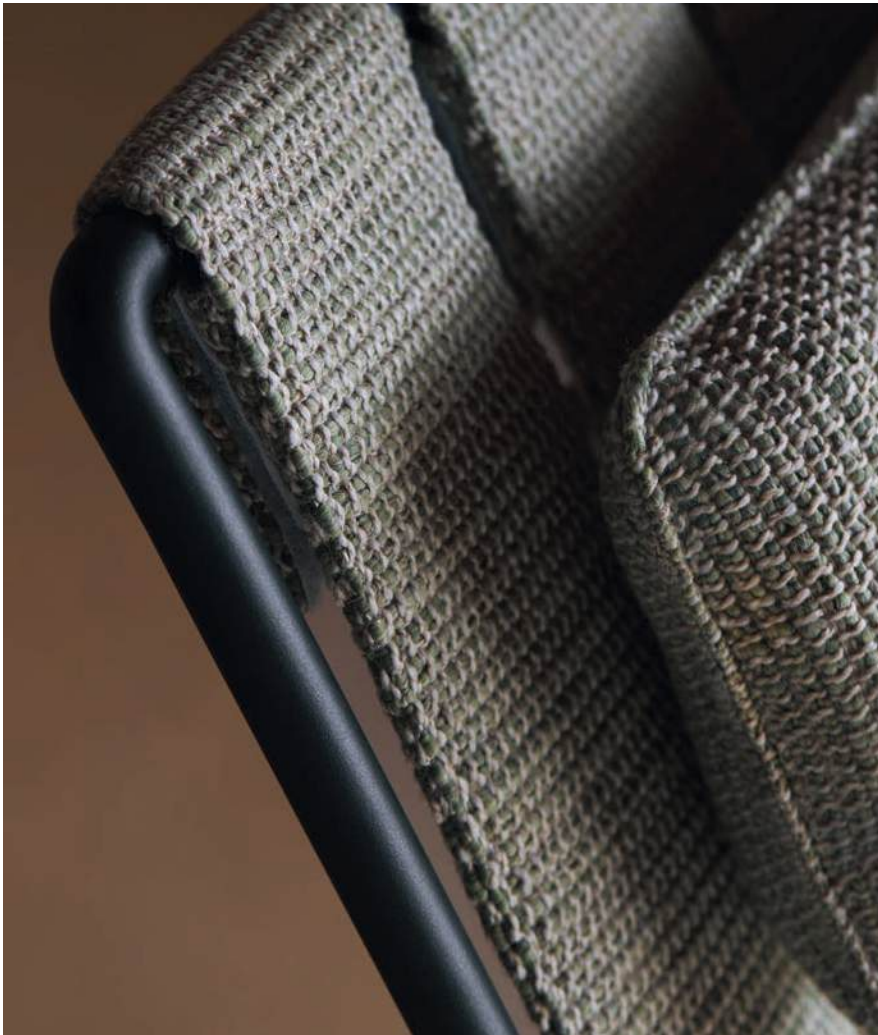

The Strappy Sunlounger translates the contemporary elegance of the Strappy Collection into a reclining design crafted for comfort and ease. Its sleek aluminium frame and signature strap detailing form a light, architectural silhouette that feels perfectly at home in any refined outdoor setting. Discreet integrated wheels make it easy to move and reposition, offering flexibility without compromising its elegant form. For added practicality, the Strappy Sunlounger is fully stackable, allowing efficient storage when not in use. Available in a curated selection of frame colours and strap finishes, it blends seamlessly into its surroundings, from a tranquil poolside to a generous terrace.





# Styletto

Designed by Kris Van Puyvelde, the Styletto Sunlounger brings effortless comfort to life through refined lines and balanced proportions. Its slender silhouette and fluid geometry express a balance between precision and ease, turning simplicity into a statement of design.

At its core lies an innovation that makes movement feel natural. A patented hydraulic system, operated by a discreet pump integrated into the frame, allows the position to adjust smoothly without interruption. Supported by gas springs and large castors, every motion is seamless, every transition intuitive.

The concept builds on a heritage of innovation first introduced with the iconic Ninix Sunlounger over two decades ago. In Styletto, that pioneering spirit evolves into a new expression of lightness and continuity, where craftsmanship and engineering merge in quiet sophistication.









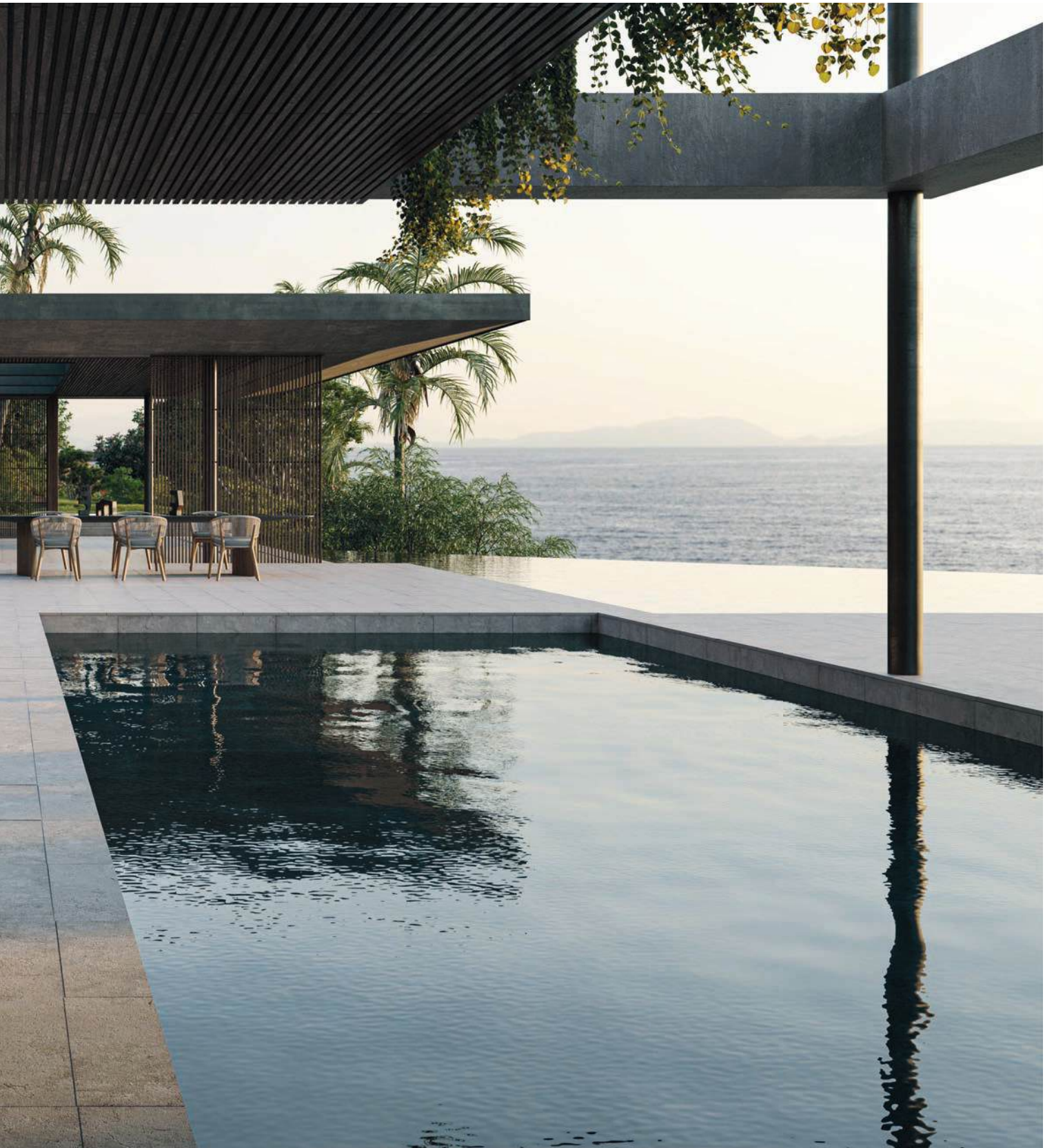



# Tuskany

The Tuskany invites you to unwind in a luxurious outdoor escape. Its distinctive teak frame, shaped with tusk-shaped curves, creates a sense of presence and serenity.

Generous, quick-drying cushions offer deep relaxation, while adjustable backrests allow effortless movement between reclining positions. Flowing curtains can be added to enclose the space in shade and calm, transforming the Tuskany into a private retreat designed for unhurried outdoor living.

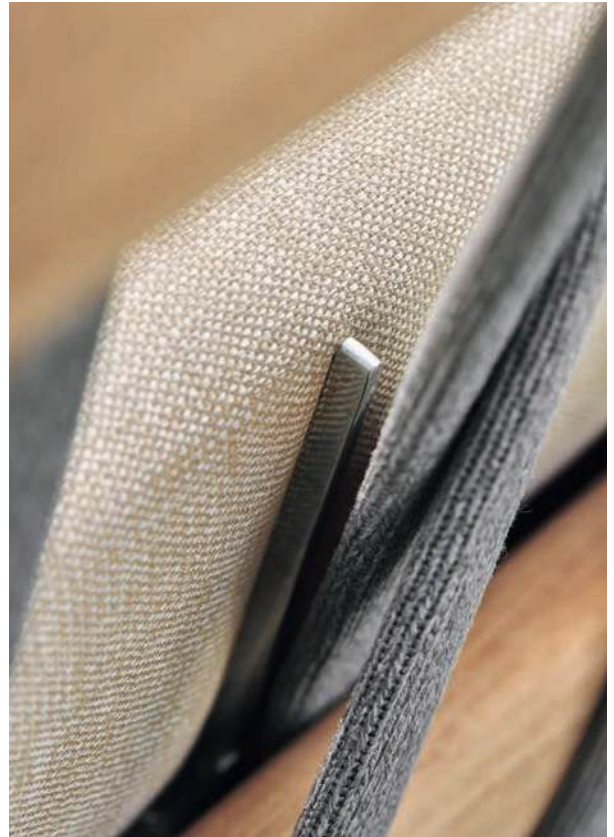





# Zenhit

Crafted from premium teak, the Zenhit Sunlounger combines lasting durability with timeless elegance. Its generous proportions offer ample space to unwind, while the integrated wheels make it easy to follow the sun throughout the day. Designed to complement the Zenhit Lounge, it completes the collection with a seamless sense of comfort and refined simplicity, inviting you to enjoy outdoor living at its most relaxed and effortless.





Alura Sun Lounger



Ninix Sun Lounger



New England Sun Lounger



O-zon Sun Lounger



QT Sun Lounger



Strappy Sun Lounger



Styletto Sun Lounger



Tuskany Daybed



Zenhit Sun Lounger



# Parasols





# Bloom

Reinvented for greater functionality and succeeding the acclaimed Palma, Bloom is equipped with a lever-operated spindle system enabling larger canopy sizes. This advanced mechanism aligns the parasols supporting ribs into a unified, organically shaped strutless structure, mirroring the elegance of a flower in bloom.

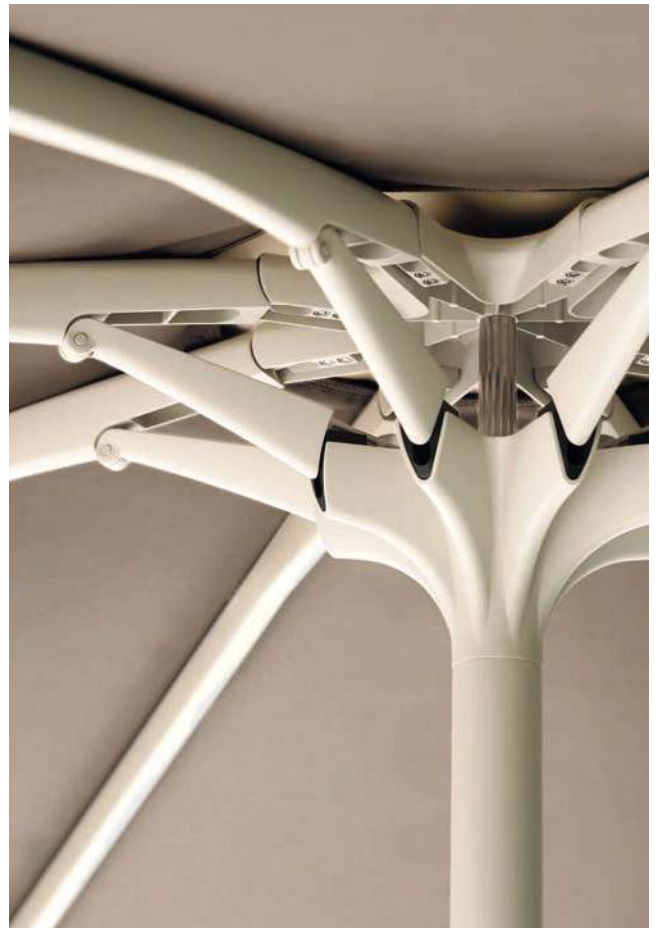

# Oazz



As the successor to the groundbreaking Palma parasol, the Oazz, designed by Kris Van Puyvelde, carries forward the same spirit of innovation in a more streamlined expression. Its automatic opening system combines intuitive functionality with refined design, bringing effortless comfort to outdoor living.

A clean structure and distinctive canopy, positioned between the ribs, give the Oazz its signature minimalist character, a pure and contemporary take on the modern parasol.





While relaxing on holiday, Kris Van Puyvelde noticed the way palm leaves moved gently in the breeze, flexible yet perfectly balanced. That observation became the spark for the Palma parasol, a design that translates the effortless motion of nature into refined engineering.

Conceived as a study in balance and innovation, Palma reimagines how a parasol can function. It was the first in the world to use a pneumatic system, opening and closing smoothly with a simple hand gesture. The design went on to receive the Red Dot Best of the Best Design Award, celebrating its pioneering spirit.

Every detail is intentionally resolved, with no visible screws or mechanical parts to disturb its purity of form. Its organic silhouette and rotating base allow the parasol to follow the sun with ease, maintaining shade and comfort throughout the day.

Crafted from durable, weather-resistant materials, Palma embodies harmony between design and function, a seamless blend of natural inspiration and technical mastery.



reddot winner  
best of the best

# Palma







# Shady

The Shady parasol exemplifies the timeless elegance that defines Royal Botania. Its refined framework, crafted with cast stainless steel fittings and premium acrylic canopies, reflects a meticulous attention to detail that elevates any outdoor setting.

Designed to endure and impress, the Shady combines craftsmanship with lasting comfort.





# Shady slim

The Shady Slim offers the signature elegance of the Shady Collection in a lighter, more compact form. Designed for terraces, balconies and intimate spaces, it provides refined shade without compromise. Combining durable materials with graceful simplicity, Shady Slim brings elegance to smaller outdoor settings while maintaining the timeless character of its larger counterpart.





# Solaz

Designed by Dirk Wynants and engineered by Kris Van Puyvelde, the Solaz Parasol elevates shade to a new level of luxury. Defined by its sculptural overhang form and wing-like opening system, it unfolds gracefully to create an impressive 3.4 x 3.4 metre canopy of light and comfort.

Every movement feels effortless. The parasol's innovative belt-driven mechanism ensures smooth, precise operation as it tilts, pivots, and rotates in every direction, allowing you to follow the sun throughout the day with ease. Despite its generous dimensions, the system operates with remarkable finesse, letting you adjust shade and direction effortlessly. The result is a parasol that blends intelligent engineering with timeless design, turning the art of shade into an experience of pure relaxation.



Bloom 330 Round



Bloom 380 Round



Bloom 275 Square



Bloom 340 Square



Oazz 300 Round



Oazz 220 Square



Palma 300 Round



Shady 30 Round



Shady 30 Square



Shady 45 Rectangle



Shady Slim 30 Round



Shady Slim 22 Square



Solaz 340 Square



# Lighting





# Club Lounge

The Club Lounge lamp brings a soft, ambient glow to outdoor spaces. Its four-leg structure, crafted from premium teak and stainless steel, combines stability with understated elegance. Available in two finishes, it offers a refined lighting solution that enhances the atmosphere of any terrace or lounge setting.

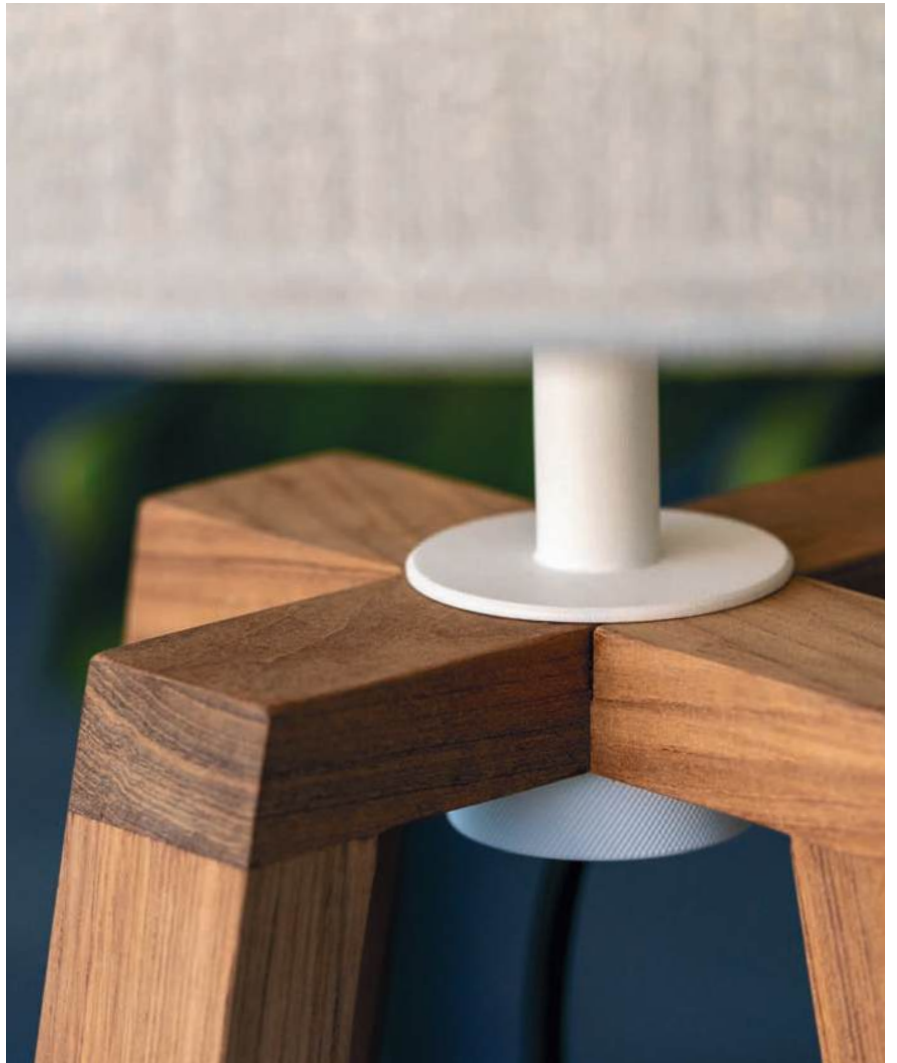

# Dome

Echoing the elegance of the 1920s, the Dome Collection combines coated aluminium with handmade glass to create a sense of timeless refinement. The design recalls the sophistication of a bygone era while remaining perfectly at home in contemporary outdoor spaces.

With its gentle glow and balanced proportions, Dome brings warmth to any setting, a subtle tribute to classic design, reinterpreted for modern living.





# Meduz

Infuse your terrace with an extra touch of luxury with our Meduz lamp. This decorative tripod lamp is a perfect statement piece, adding an artistic flair to any high-end terrace setting.





# Luniz

With its three gracefully branching arms, it forms a natural companion to any lounge arrangement, casting a soft and inviting glow.

Each lampshade can be customized in three sizes and a curated palette of fabrics, allowing for subtle variation in tone and proportion. The base can also be finished with a selection of fine ceramics, adding a distinctive layer of texture and individuality.



The powder-coated aluminium frame is elegantly wrapped in decorative polyolefin rope, available in black, green, or sand. By day, an integrated solar panel stores energy in a high-capacity battery, providing a warm, lasting glow long after sunset. The lamp can also be recharged via USB connection when needed.

Available as a compact table model or a larger version with a convenient handle, it brings light and atmosphere wherever you go.



# Ropy



The Tristar outdoor lamp combines timeless materials with subtle detailing. Its frame, crafted from teak or coated stainless steel, is paired with handmade glass that reveals the care of true craftsmanship.

Available in two sizes and with a choice of clear or smoke glass, the Tristar brings a warm, refined glow to any outdoor setting.

# Tristar



# Planters



# Bariq



The Bariq planter draws its character from organic form and natural materiality. Its gently rounded shape is wrapped in meticulously aligned teak slats that follow the curve of the design with seamless precision.

Crafted from premium teak, the Bariq combines warmth and durability, adding a natural elegance that complements any outdoor setting.





The Botaniq Planters combine clean geometry with solid craftsmanship, creating pieces that feel timeless and refined. Their balanced proportions allow them to integrate naturally into any outdoor environment, from terraces and entryways to landscaped gardens.

Defined by simplicity and strength, the Botaniq Planters adds structure to outdoor spaces.



# Botaniq



# Cuprum

Time gives the Cuprum planters their distinctive character. Crafted from solid brass, their surface develops a warm patina that deepens with the seasons, transforming sunlight into a soft, golden reflection. Each piece adds a subtle glow and quiet richness to its surroundings, whether standing alone or arranged together as sculptural accents.

For contemporary settings, Cuprum is also available in colour fast, UV resistant polyester, offering a modern interpretation of the same enduring design, suited for both indoor and outdoor spaces.



# Poufs & Rugs



# Tono



The Tono pouf is designed for easy, adaptable living. Beneath its clean silhouette lies a practical storage compartment, perfect for keeping small items close at hand. The cushioned top serves as a comfortable seat or footrest and can be removed effortlessly for quick access inside.

Available in a variety of colours and textures, the Tono pouf complements any lounge arrangement, adding both function and character to outdoor spaces.



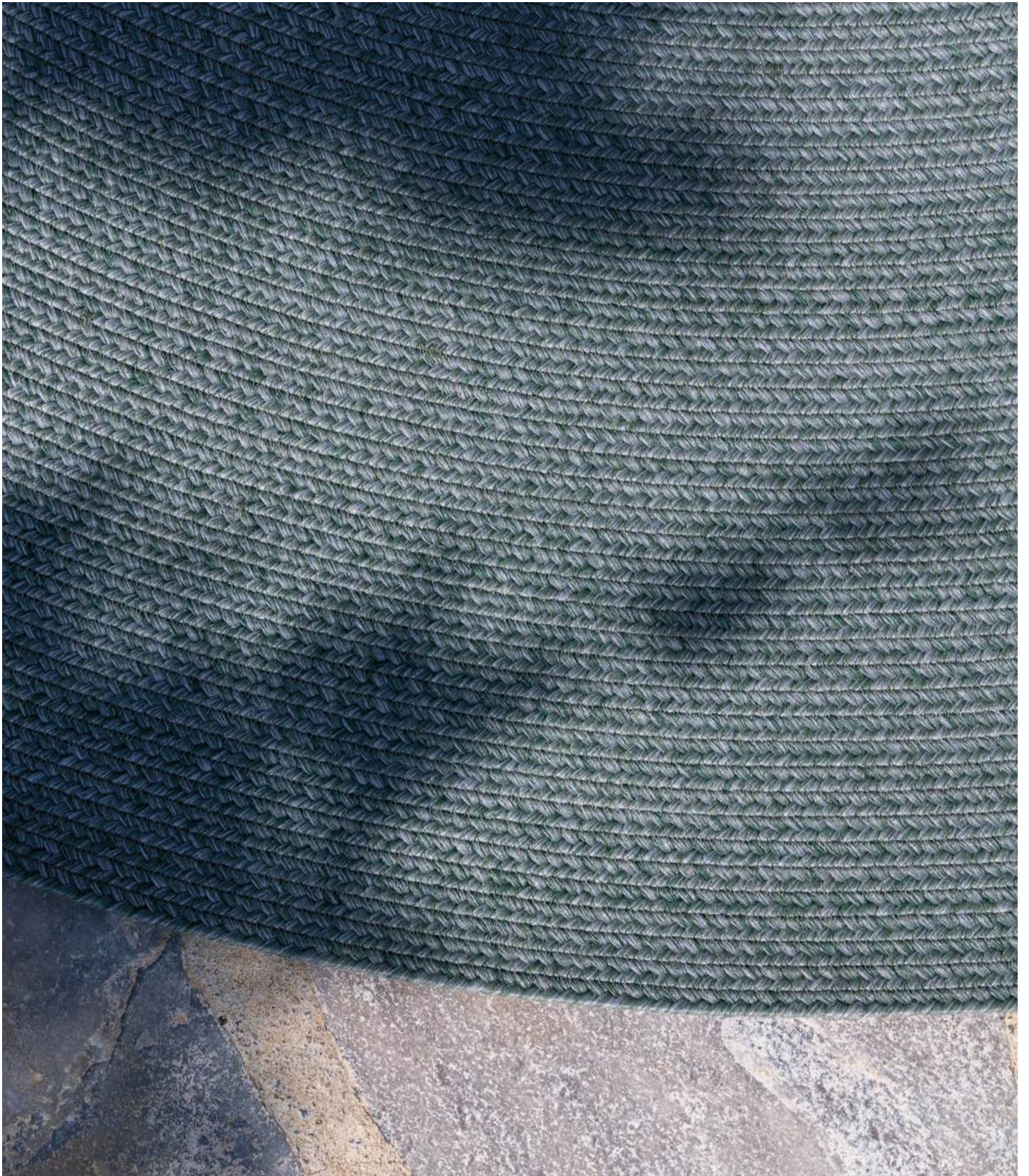

# Rugs

Soft, subdued colours and beautifully woven Olefin fibres define the Royal Botania rugs. Designed to add texture and warmth underfoot, they integrate naturally into any refined outdoor environment, complementing the materials and tones of surrounding furniture.

The collection includes square and round rugs, available in four sophisticated shades: Bark, Rock, Granite and Olive, offering a subtle foundation for outdoor living.

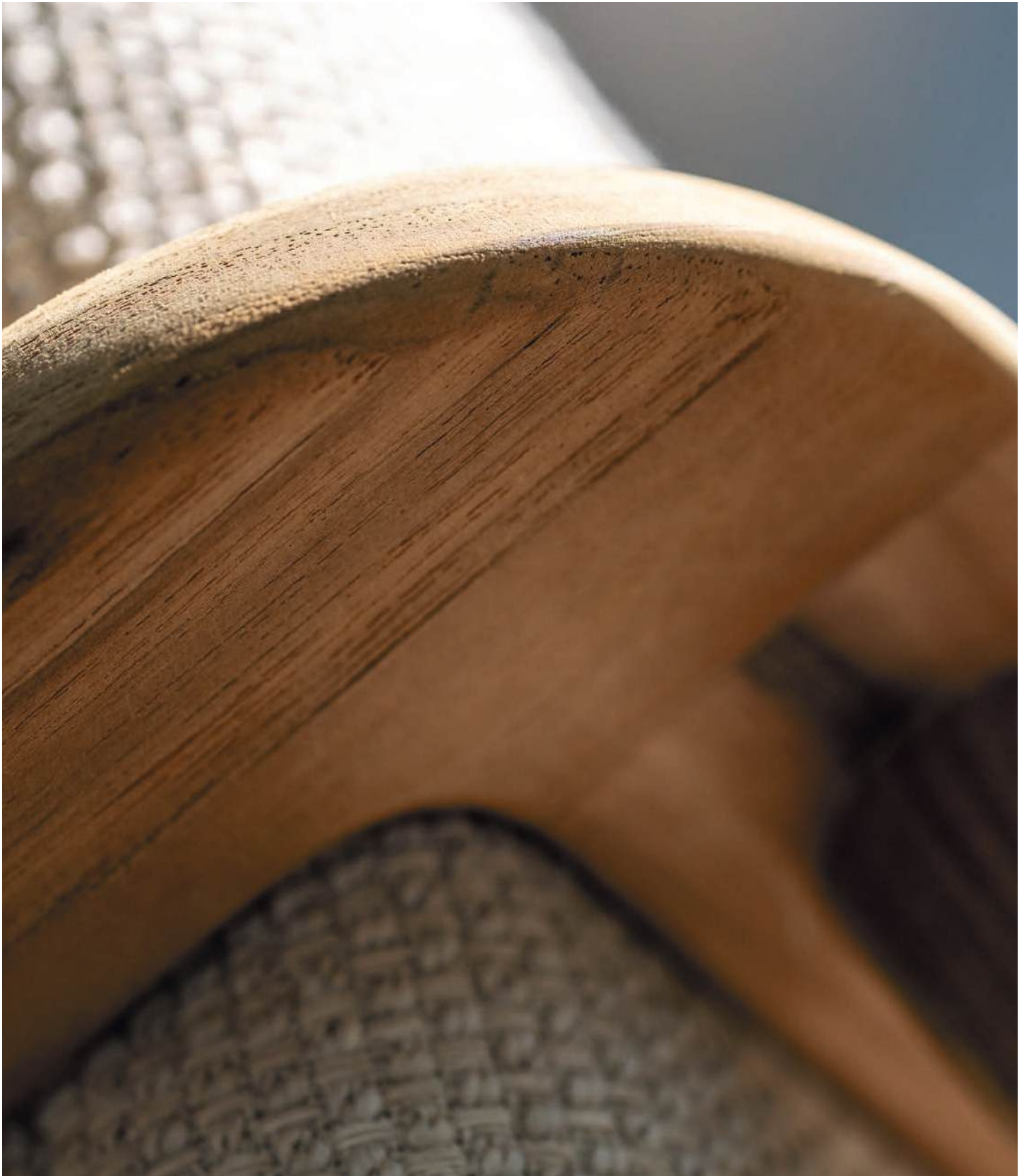

# Maintenance

From teak and aluminum to stainless steel and glass, our maintenance solutions allow you to enhance the longevity of your outdoor furniture. While our materials are selected for their resilience to natural elements, our products provide extra protection, keeping your pieces looking as luxurious as the day you brought them home.

For those who want to maintain every detail, we offer the perfect solutions for any material used in our collections.

More information about our maintenance products:



# Covers

While Royal Botania furniture is built to withstand the harshest outdoor elements, our custom-designed covers provide an added layer of protection, ensuring your pieces remain as pristine as the day you first placed them outdoors.

Though not essential, these covers help maintain the “like-new” appearance of your furniture for even longer.

Made to fit perfectly across all our collections, these durable covers shield against dirt, moisture, and the everyday wear of outdoor environments. Using our covers means less cleaning and less exposure to the elements, extending the lifespan of your furniture and preserving its luxurious look year after year.



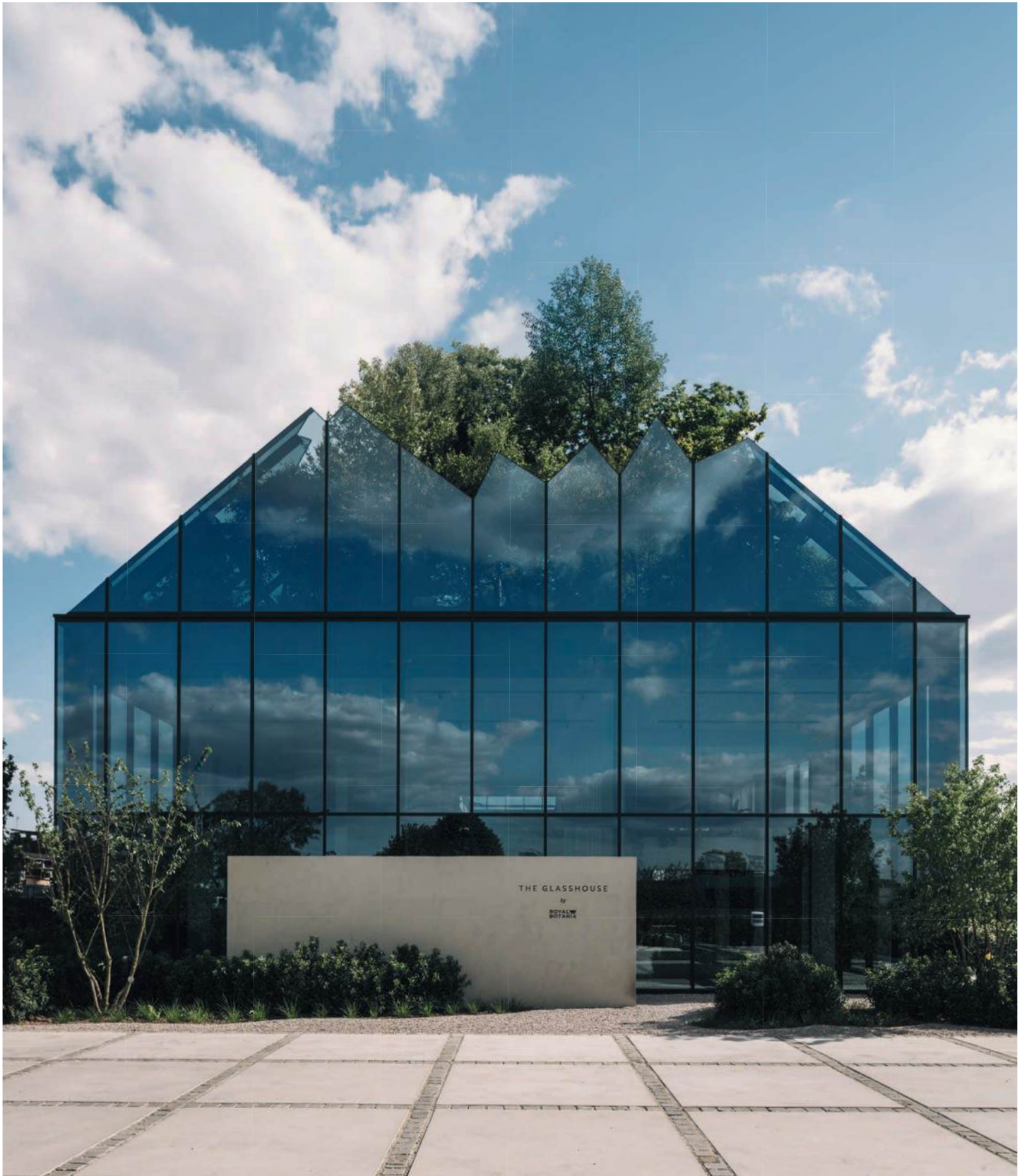

# The Glasshouse

Welcome to The Glasshouse, our newest 3,000 m<sup>2</sup> showroom, a unique space where design, refined outdoor living, and innovative technology come together in perfect harmony. Situated alongside one of Belgium's busiest highways, The Glasshouse welcomes visitors into an atmosphere of tranquility, light, and elegance.

Inspired by the architecture of classic greenhouses, the building features a light, transparent structure that seamlessly blurs the line between indoors and outdoors. Spread across three floors, The Glasshouse offers generous space to explore our collections. More than just a showroom, it is a place of connection and inspiration, where architects and partners can come to exchange ideas and get inspired.

With its glass facades and open character, The Glasshouse radiates openness and light. Behind this architectural vision lies a strong commitment to sustainability. A significant portion of the glass is fitted with integrated solar panels, contributing to a nearly energy-neutral operation. Powered by advanced systems including heat pumps and thermal energy storage, the building is almost entirely self-sufficient throughout most of the year.

Royal Botania warmly invites you to discover The Glasshouse, a place where outdoor living flows inside, and where architecture, nature, and experience blend effortlessly.











# Partnerships & Projects





Royal Botania's luxurious outdoor furniture is the choice for exclusive projects worldwide, from stunning hotels and renowned restaurants to prestigious private residences and yachts.

Our bespoke solutions, exceptional craftsmanship, and timeless designs make us the ideal partner for architects, designers, and developers looking to create extraordinary outdoor spaces. Whether your project is large or small, we provide unparalleled expertise and support.

For more information or to discuss your project needs, don't hesitate to contact us.

## **HEADQUARTERS**

Royal Botania nv  
Elsendonkstraat 146  
2560 Nijlen  
Belgium  
Tel.: +32 (3) 411 22 85

## **US OFFICE**

Royal Botania Inc.  
200. Lexington Ave Suite 400  
New York

## **OUR SHOWROOM**

The Glasshouse  
Koralenhoeve 3  
2160 Wommelgem  
Belgium

Follow us

[instagram.com/royalbotania](https://www.instagram.com/royalbotania)  
[facebook.com/RoyalBotania](https://www.facebook.com/RoyalBotania)  
[linkedin.com/company/royal-botania/](https://www.linkedin.com/company/royal-botania/)

Copyright © 2026 Royal Botania

All rights reserved.  
No part of this publication may be reproduced, stored in a retrieval system or transmitted in any form or by any means, electronic, mechanical, photocopying, recording, or otherwise, without the prior consent of Royal Botania.

Printed in Belgium